

D-SUB High density R/A PCB MALE MACHINE PIN(8.89mm FOOTPRINT)

ROHS COMPLIANT

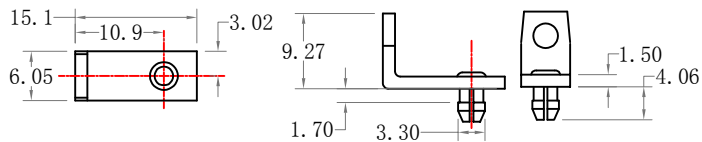
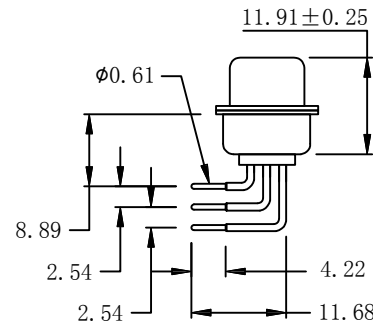
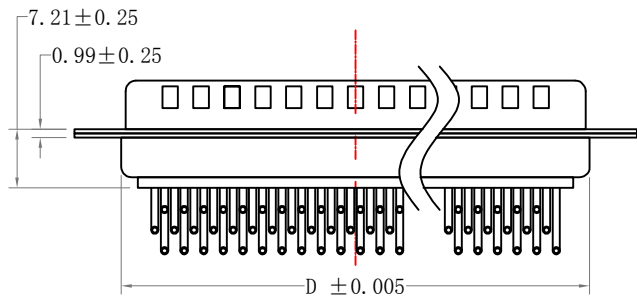
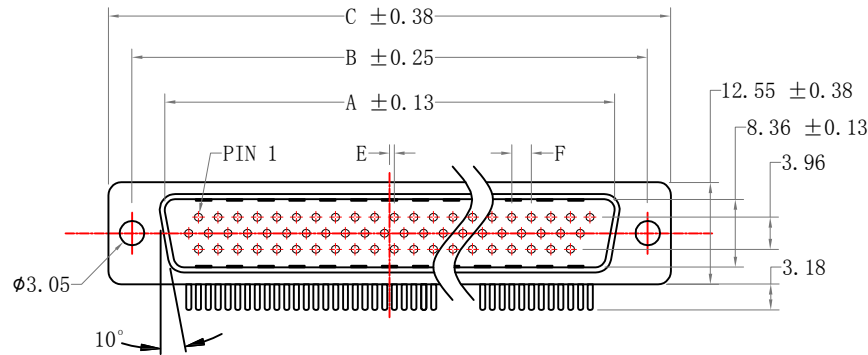

MOUNTING BRACKET WITH BOARD LOCK

MATERIALS AND FINISH

SHELL: STEEL MATERIAL, FRONT SHELL NICKEL FINISHED
 BACK SHELL NICKEL FINISHED
 INSULATOR: PBT THERMOPLASTIC, 30% GLASS
 FILLED, UL 94V-0 RATED, WHITE COLOR
 CONTACT MATERIAL: BRASS
 CONTACT FINISH: FULL 2u" GOLD

ELECTRICAL CHARACTERISTICS

CONTACT CURRENT RATING : 5.0 AMPS
 CONTACT RESISTANCE : 30 MILLIOHMS MAX.
 DIELECTRIC WITHSTANDING VOLTAGE : 1000 V AC MIN
 INSULATION RESISTANCE : 5000 MEGAOHMS MIN
 TEMPERATURE RATING : -55°C ~ +105°C

Ordering Code:

MHDR01 - M - X - X - X - X
 ① ② ③ ④ ⑤ ⑥

- ① MHDR Series
- ② Contact Type:
M: male
- ③ Contact NO. :
15=15pin 26=26pin
44=44pin 62=62Pin
- ④ Mounting Option:
A: No accessories
B: BRACKET WITH #4-40 INSERT,
BOARD LOCK AND LOCATOR PLATE
- ⑤ Insulation Color Code:
B: Black G: Grey
W: White L: Blue
- ⑥ Contact Plating
S: Selective Gold
G0: Gold flash G1: 3u" Gold
G2: 5u" Gold G3: 10u" Gold
G4: 15u" Gold G5: 30u" Gold

DIMENSIONS (mm)						
No. OF PINS	A	B	C	D	E	F
15	16.92	25.00	30.81	19.28	0.25	2.29
26	25.25	33.33	39.14	27.51	0.51	2.29
44	38.96	47.04	53.04	41.28	0.51	2.29
62	55.42	63.50	69.32	57.71	0.58	2.39

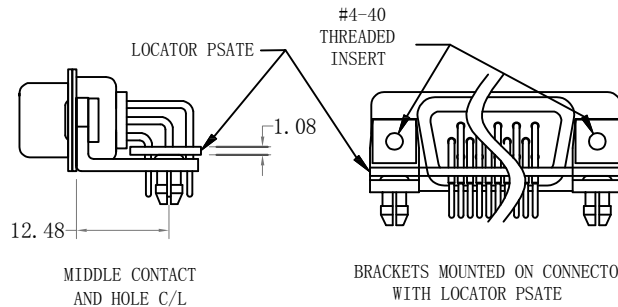

Unless Otherwise specified tolerance X±0.35 X.X±0.25 X.XX±0.20 X.XXX±0.15		CELION SAS
SCALE: 1:1	UNIT: mm	
DRAWN: junfon H CHECKED: YANG		TITLE: D-SUB High density R/A PCB MALE MACHINE PIN(8.89mm FOOTPRINT)
DATE: 12/4/27		DRAWING NO: MHDR01-MXXXXX
3rd ANGLE PROJECTION		PRODUCT NO: MHDR01-MXXXXX