

RoHS Compliant

REV.	ECN NO.	DESCRIPTION	REVISER	DATE
A0		新版本	H.H.F	15-07-06

NOTE:

- MATERIALS AND FINISHED
 INSULATOR : PBT+30% GF UL 94V-0,
 SHELL : STEEL, NI OR SN FINISHED
 CONTACT MATERIAL : BRASS, SELEVITE GOLD FINISHED
 RIVETED INSERT: BRASS MATERIAL ,TIN FINISHED
 WITH #4-40 THREADED ASSEMBLED
- ELECTRICAL CHARACTERISTICS
 CURRENT RATING : 1.0 AMP DC
 VOLTAGE RATING: 300 V DC
 CONTACT RESISTANCE :20 MILLIOHMS MAX.
 DIELECTRIC WITHSTANDING VOLTAGE : 500 V AC MIN.
 INSULATION RESISTANCE : 1000 MEGAOHMS MIN.
- ENVIRONMENTAL
 OPERATING TEMPERATURE: -55°C ~ +85°C
 STORAGE TEMPERATURE:-55°C ~ +105°C
- HOW TO ORDER:

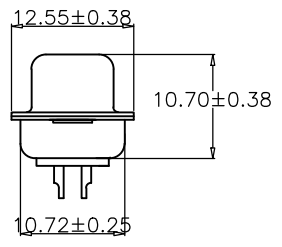
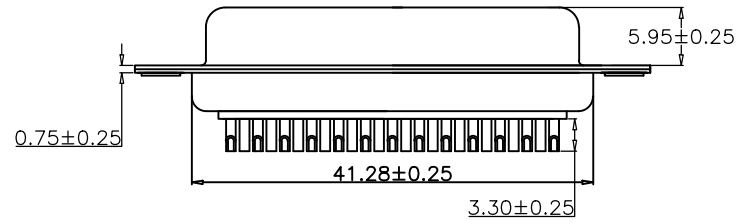
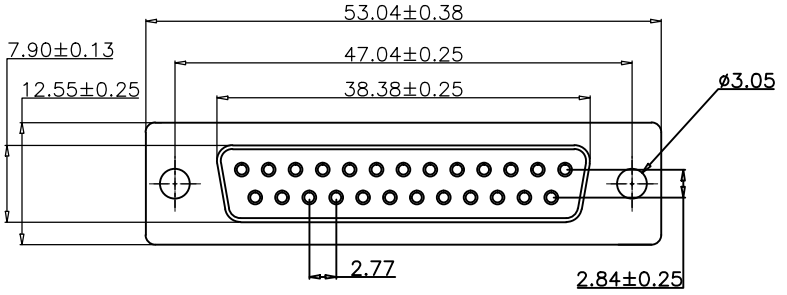

DB F 2 1 1-25 G X X X P-A 0 0 1 0

Female

25:25PIN

G:Gold Plating
S:Selevite Gold Bright TIN

1:1u"
2:2u"
3:3u"
7:15u"

1:FORNT SHELL NI
BLACK SHELL SN

4.FULL Gold
5.FULL NI

0:RoHS

A:No screw type
B:Ass'y screw type
C:Attach screw type
D:Fork Lock

P:PBT

B:Black
L:LIGHT Blue
W:White

比例(Scale):1:1	图号(DWG NO.)	CELION SAS		
单位(Unit):mm	设计(Design)			H.H.F
未注公差 Tolerance Unspecified	审核(Checked)			
X. ±0.38 X.X ±0.35 X.XX ±0.25 X.XXX ±0.15 X.' ±2' X.XX' ±0.5' X.X' ±1'	核准(Approved)		品名(Title):	DB 25母头车针焊线, 端子全金15u黑胶, 铆合光孔
	页次(Sheet)	1 OF 1	料号P/N):	DBF 211-25GXXXP-A0010
	版次(Rev.):A0			