

TOLERANCE: ±0.05, THICKNESS: 1.2mm  
RECOMMENDED PCB LAYOUT  
(TOP VIEW)

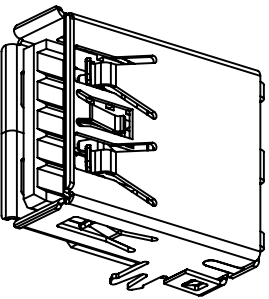
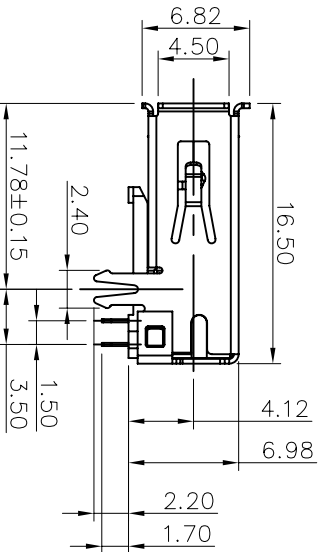

- NOTES:  
1.ELECTRONIC:  
CONTACT RESISTANCE: 30mohm MAX  
INSULATION RESISTANCE: 1000 Mohm MIN  
WITHSTAND VOLTAGE: AC 500V,1min.  
2.MECHANICAL:  
DURABILITY: 1500 CYCLE.  
3.ENVIRONMENT CHARACTERISTICS:  
OPERTING TEMPERATURE: -55°C TO +105°C  
4.RECOMMANDER PCB THICKNESS 1.2 TO 1.60MM

5	SHELL	1	COPPER ALLOY	NI PLATED
4	SPIN	5	COPPER ALLOY	30U AU/TIN PLATED
3	4PIN	4	COPPER ALLOY	30U AU/TIN PLATED
2	COVER	1	(LCP)THERMOPLASTIC	(UL 94V-0) BLUE
1	HOUSING	1	(LCP)THERMOPLASTIC	(UL 94V-0) BLUE
No.	PART NAME	QTY	MATERIAL	REMARK

### CELION SAS

DESCRIPTION		USB3.0 A/T FEMALE 90度 DIP 带鱼叉板下型		
DRAWING NO	BT160721-001	PART NO	BUSF09L1N6237	
THIRD ANGLE PROJECTION	REVISION	A	UNIT	MM
	LINEAR	±0.50	SCALE	N/A
	ANGLE	±5°	SHEET	1/1
	X.X	±0.38	CHECKED	APPROVED
	X.XX	±0.25		

