

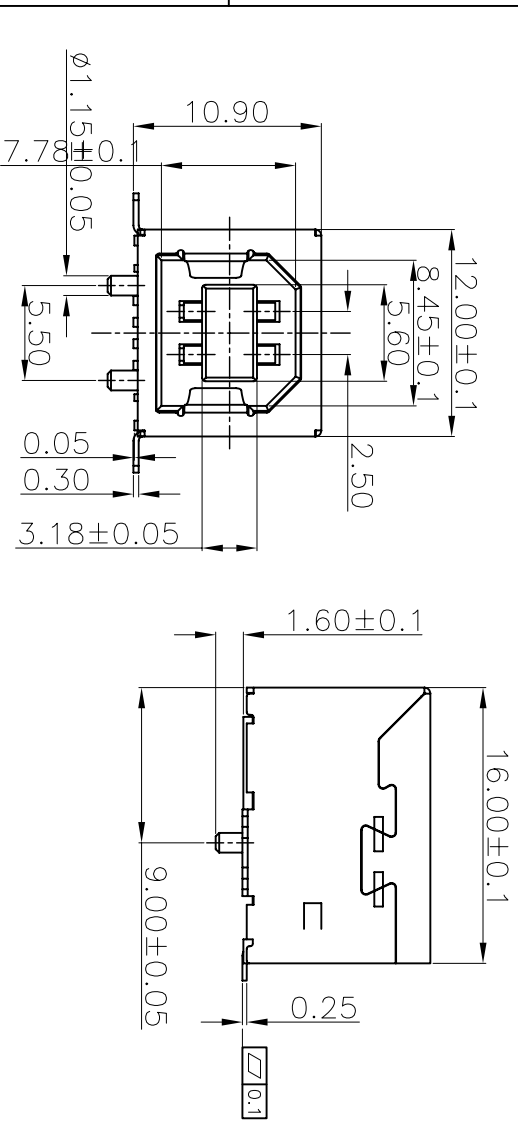

REV.	DESCRIPTION	DATA	DRAW	APPD
A0	NEW	2011.07.26	Royden	

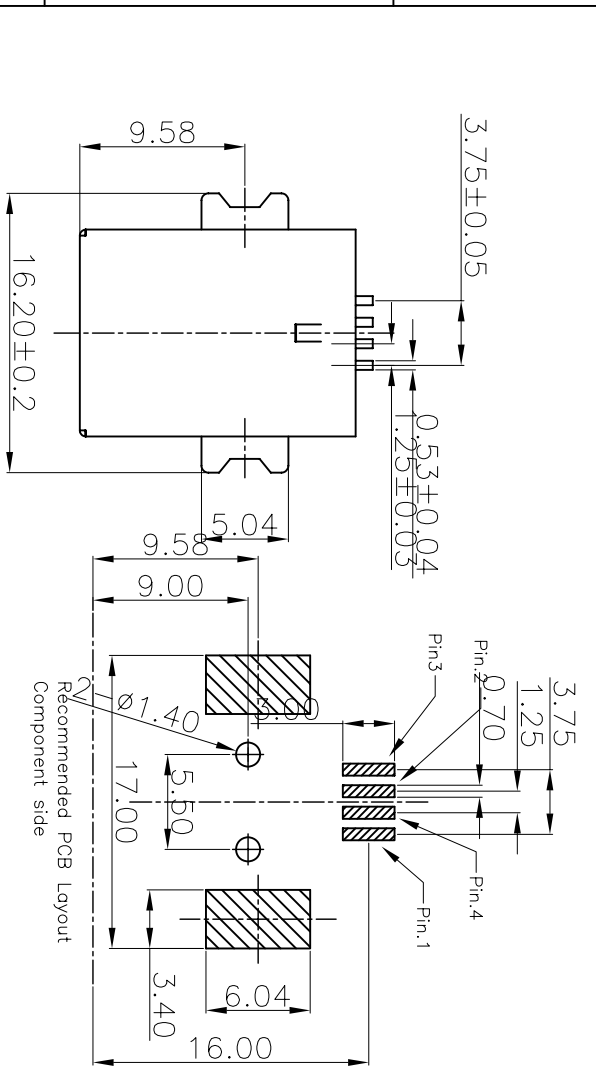

- NOTES:
- 1.ELECTRONIC:
CONTACT RESISTANCE: 30mohm MAX
INSULATION RESISTANCE: 1000 Mohm MIN
WITHSTAND VOLTAGE:AC 500V,1min.
 - 2.MECHANICAL:
DURABILITY: 1500 CYCLE.
 - 3.ENVIRONMENT CHARACTERISTICS:
OPERATING TEMPERATURE:-55°C TO +105°C
 - 4.RECOMMANDER PCB THICKNESS 1.0 TO 1.60MM

No.	PART NAME	QTY	MATERIAL	REMARK
3	SHELL	1	COPPER ALLOY	NI PLATED
2	CONTACT	9	COPPER ALLOY	AU/TIN PLATED
1	HOUSING	1	LCP UL94V-0	(UL 94V-0) BLACK

CELLION SAS

DESCRIPTION	USB2.0 B/T	FEMALE SMT
DRAWING NO	110726-001	PART NO. BUSF04B1N1119

THIRD ANGLE PROJECTION	REVISION	AO	UNIT	MM	DRAWN	ROYDEN
	X.	±0.50 X.	±5°	N/A	CHECKED	
	X.X	±0.38 X.X	±2°		APPROVED	
	XXX	±0.25 X.XX	±1°			