

10 9 8 7 6 5 4 3 2 1

PART NO. 660300TAxxx
 DWG NO. C6603TA

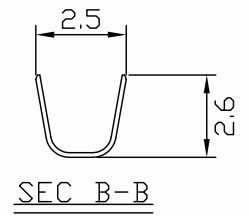
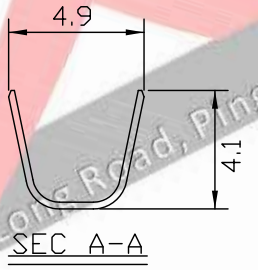
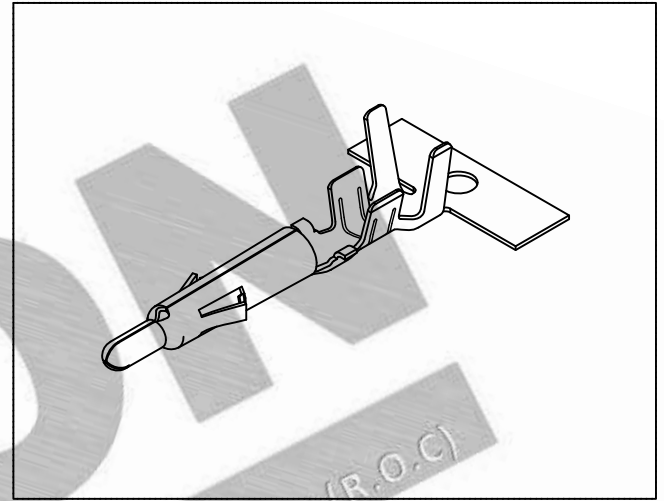
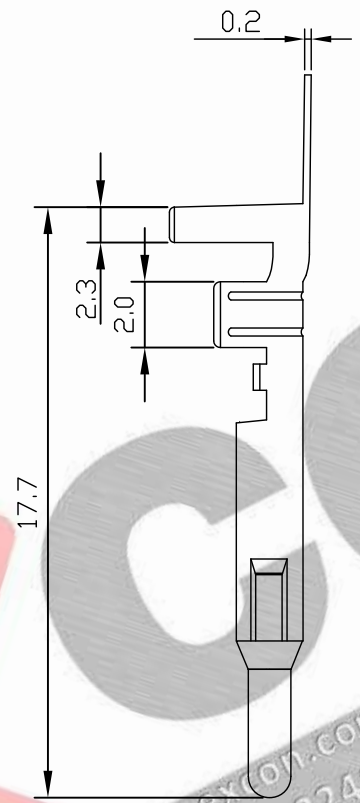
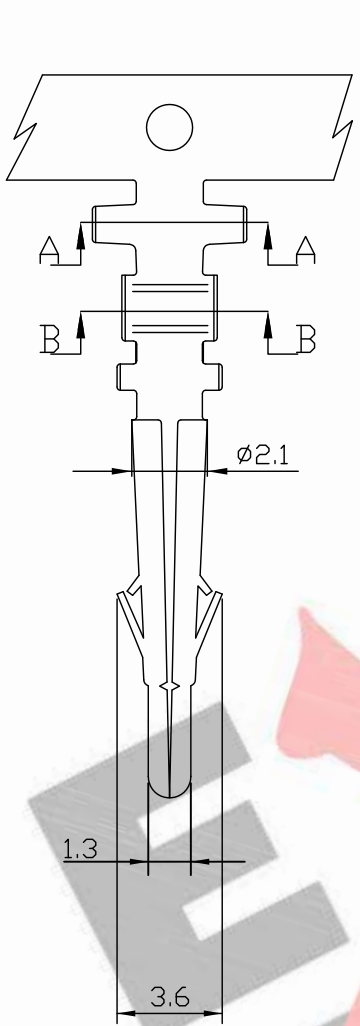

NOTE:

1. Terminal Material:
Brass bronze or Phosphor
2. Plated: Tin pre-plated 50u"min.
3. Applicable wires: AWG#20-#16
4. Insulation O.D.: 3.4mm (max)
5. Q'ty / reel:4,000 pcs

Part No.	Wire Range	Insulation O.D.	Material
660300TA051	AWG#20~#16	1.9-3.4mm	Brass
660300TA351	AWG#20~#16	1.9-3.4mm	Phosphor

				UNLESS OTHERWISE SPECIFIED TOLERANCES		
				3 PLACE ±0.5 ±0.10		
				2 PLACE ±1.5 ±0.25		
				1 PLACE ±2.0 ±0.50		EXCON TECHNOLOGY COMPANY
				ANGLE DIM		
REV.	REVISIONI			DIS	DATE	
SCALE	REV.	PAGE:	UNIT	mm		DWG NO:
3/1	A	1	THIRD ANGLE PROJECTION			C6603TA
					PART.NO	
					660300TAxxx	

www.excon.com.tw
 89, Xing Long Road, Ping Zhen Dist., 32460 Taoyuan City, Taiwan (R.O.C)

10 9 8 7 6 5 4 3 2 1

10 9 8 7 6 5 4 3 2 1

PART NO. 660300TBxxx
 DWG NO. C6603TB

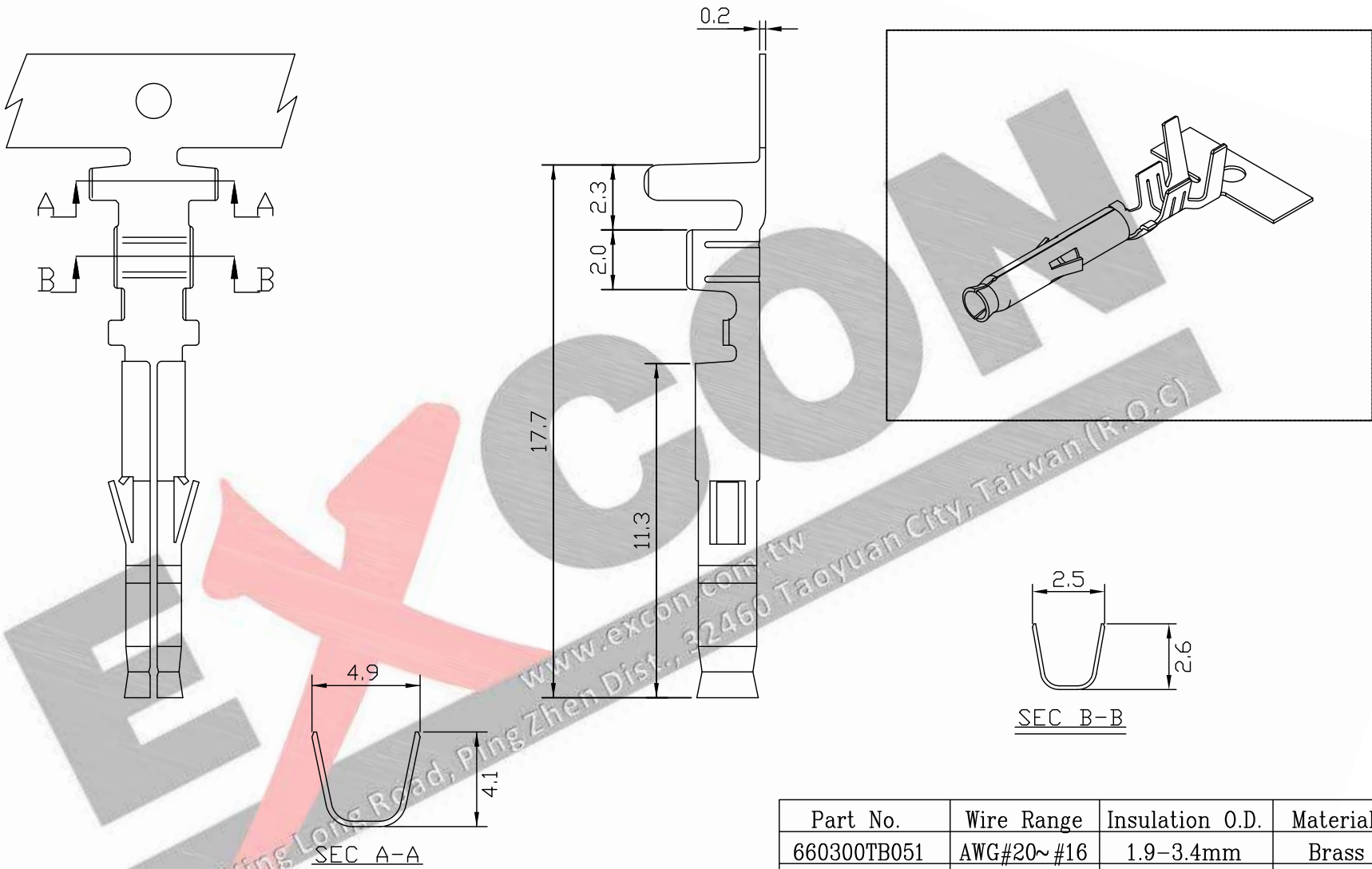

NOTE:

1. Terminal Material:
Brass bronze or Phosphor
2. Plated: Tin pre-plated 50u"min.
3. Applicable wires: AWG#20-#16
4. Insulation O.D.: 3.4mm (max)
5. Q'ty / reel:4,000 pcs

Part No.	Wire Range	Insulation O.D.	Material
660300TB051	AWG#20~#16	1.9-3.4mm	Brass
660300TB351	AWG#20~#16	1.9-3.4mm	Phosphor

				UNLESS OTHERWISE SPECIFIED TOLERANCES		EXCON EXCON TECHNOLOGY COMPANY
				3 PLACE ±0.5 ±0.10		
				2 PLACE ±1.5 ±0.25		
				1 PLACE ±2.0 ±0.50		
				ANGLE DIM		
REV.	REVISIONI			DIS	DATE	
SCALE	REV.	PAGE:	UNIT	mm		DWG NO:
3/1	A	1	THIRD ANGLE PROJECTION			C6603TB
					PART.NO	
					660300TBxxx	

E D C B A

F E D C B A

89, Xing Long Road, Ping Zhen Dist., 32460 Taoyuan City, Taiwan (R.O.C)

www.excon.com.tw

10 9 8 7 6 5 4 3 2 1

10 9 8 7 6 5 4 3 2 1

PART NO. 660300TMxxx
 DWG NO. C6603TM

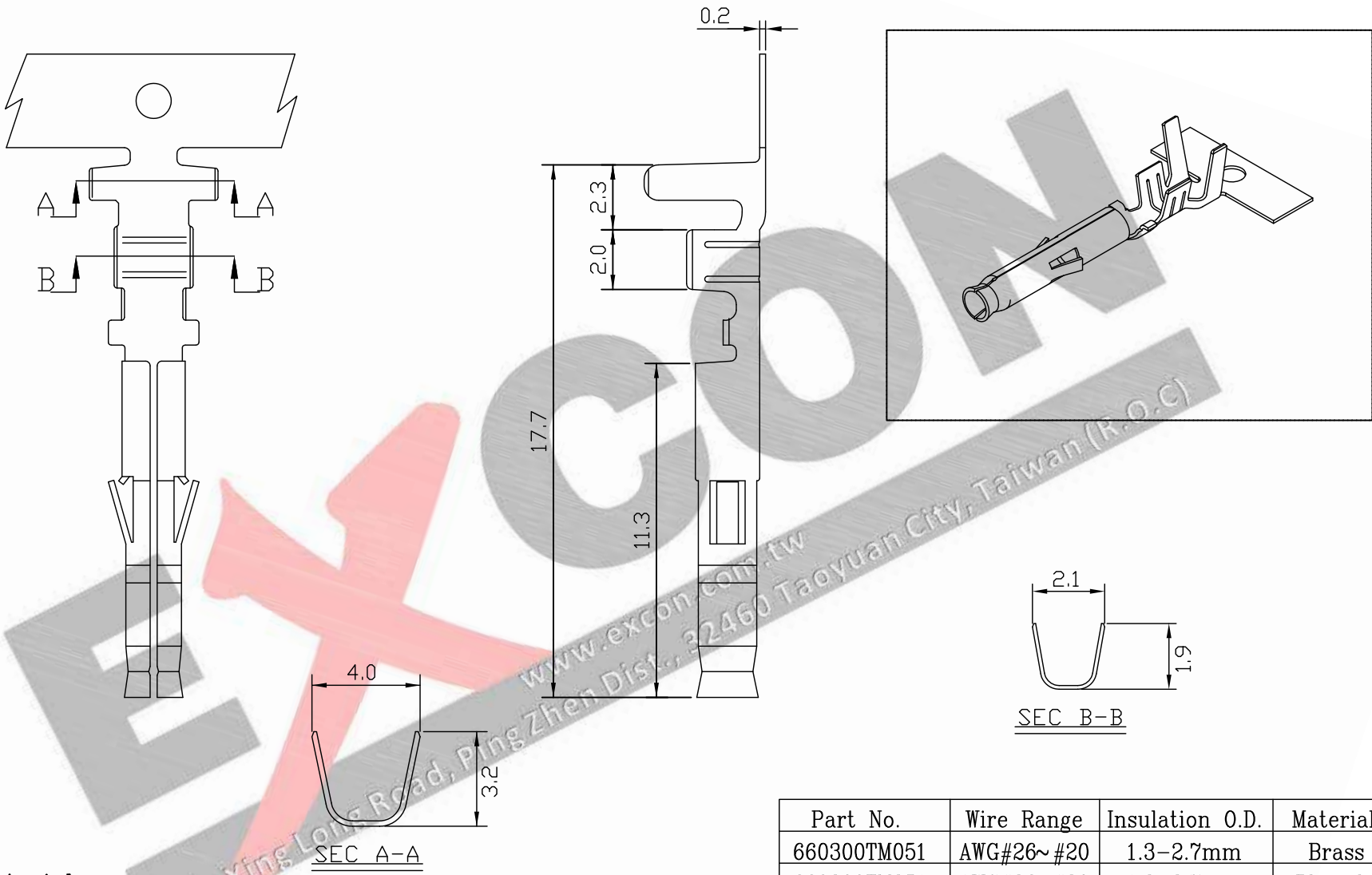

NOTE:

1. Terminal Material:
Brass bronze or Phosphor
2. Plated: Tin pre-plated 50u"min.
3. Applicable wires: AWG#26-#20
4. Insulation O.D.: 2.7mm (max)
5. Q'ty / reel:7,000 pcs

Part No.	Wire Range	Insulation O.D.	Material
660300TM051	AWG#26~#20	1.3-2.7mm	Brass
660300TM351	AWG#26~#20	1.3-2.7mm	Phosphor

				UNLESS OTHERWISE SPECIFIED TOLERANCES		 EXCON TECHNOLOGY COMPANY
				3 PLACE ±0.5 ±0.10		
				2 PLACE ±1.5 ±0.25		
				1 PLACE ±2.0 ±0.50		
				ANGLE DIM		
REV.	REVISIONI			DIS	DATE	
SCALE	REV.	PAGE:	UNIT	mm		DWG NO:
3/1	A	1	THIRD ANGLE PROJECTION			C6603TM
					PART.NO	
					660300TMxxx	

10 9 8 7 6 5 4 3 2 1

PART NO. 660300TPxxx
 DWG NO. C6603TP

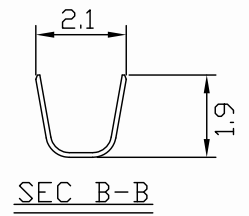
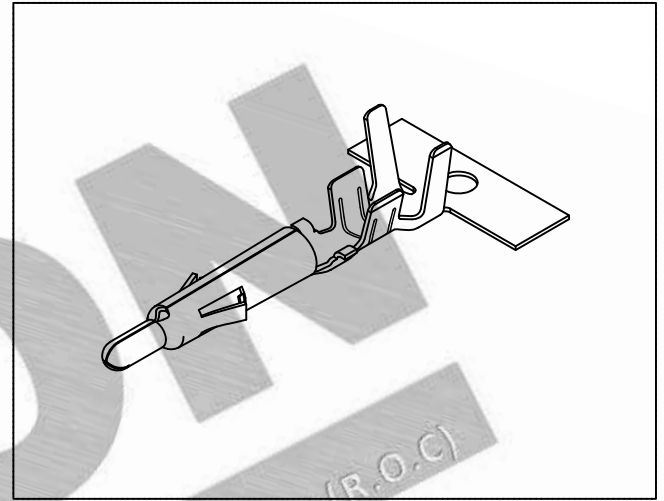
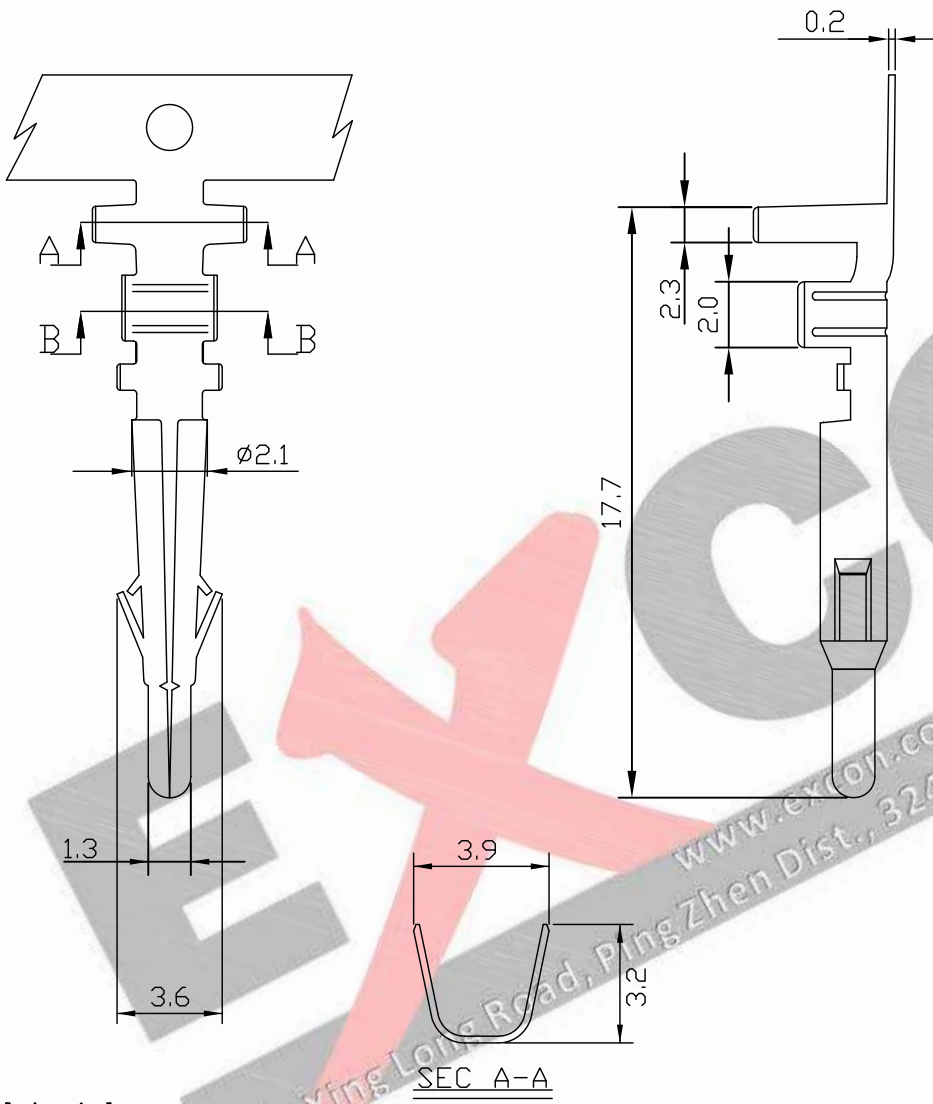

NOTE:

1. Terminal Material:
Brass bronze or Phosphor
2. Plated: Tin pre-plated 50u"min.
3. Applicable wires: AWG#26-#20
4. Insulation O.D.: 2.7mm (max)
5. Q'ty / reel: 7,000 pcs

Part No.	Wire Range	Insulation O.D.	Material
660300TP051	AWG#26~#20	1.3-2.7mm	Brass
660300TP351	AWG#26~#20	1.3-2.7mm	Phosphor

REV.	REVISION	DIS	DATE	UNLESS OTHERWISE SPECIFIED TOLERANCES 3 PLACE $\pm 0.5 \pm 0.10$ 2 PLACE $\pm 1.5 \pm 0.25$ 1 PLACE $\pm 2.0 \pm 0.50$ ANGLE DIM		
SCALE	REV.	PAGE	UNIT			MM
3/1	A	1	THIRD ANGLE PROJECTION		C6603TP	660300TPxxx