

PART NO. 420200TAxxx
 DWG NO. C4202TA

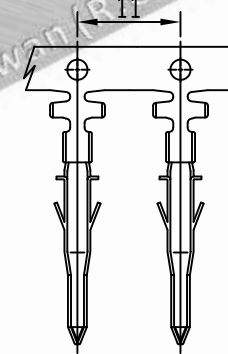
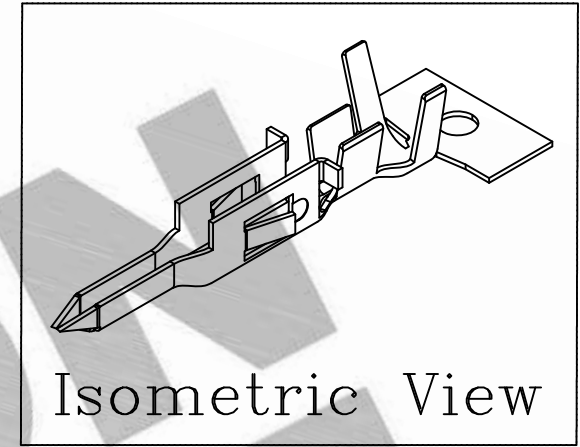
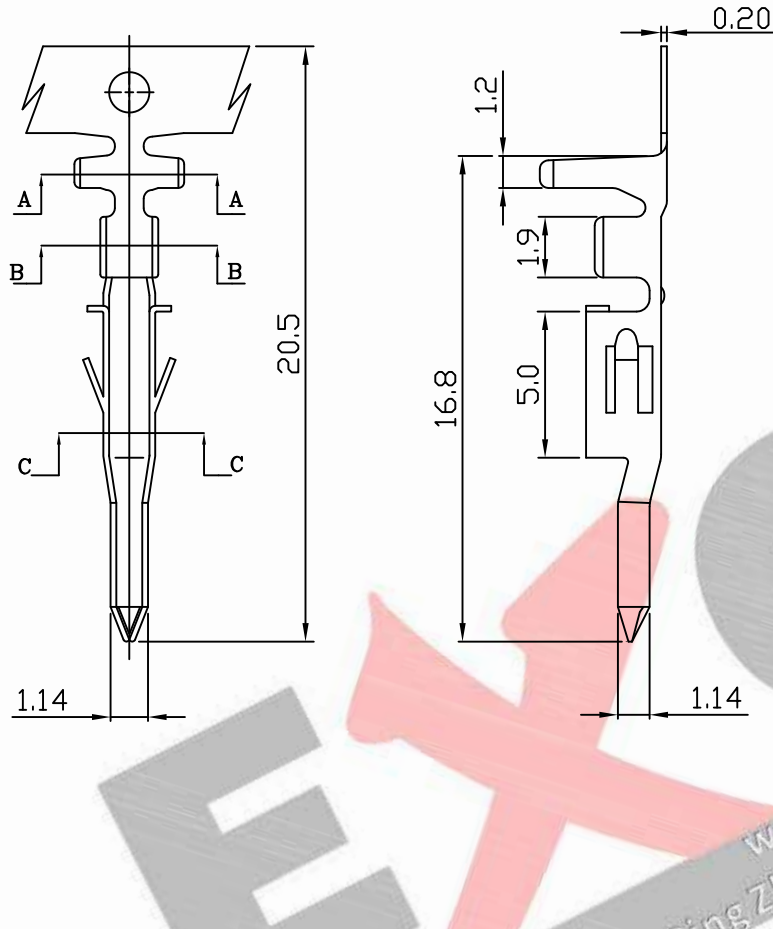

NOTE:

1. Terminal Material: Brass bronze or Phosphor bronze
- ⚠ 2. Plated: Tin pre-plated 50u"min.
- ⚠ 3. Current rating: 5A AC/DC
- ⚠ 4. Voltage rating: 600V AC/DC
- ⚠ 5. Withstand voltage: 1500V AC/minute
- ⚠ 6. Insulation resistance: 1000MΩ min
7. Insulation O.D.: 1.1~2.1mm
8. Q'ty / reel: 4,000pcs

Dimensional & Ordering Information:

No.	Part No.	Wire Range	Material	Finishing
1	420200TA051	AWG#24~#18	Brass	Tin pre-plated
2	420200TA351	AWG#24~#18	Phosphor	Tin pre-plated

REV.	REVISIONI		DIS	DATE
C	DWG RELEASE		Christy	12/24 2015
B	NOTE: 修改 第 2 項 Tin-Plated → Tin pre-Plated 新增 第 3、4、5、6 項及數厚 T0.2		Christy	5/28 2015
SCALE	REV.	PAGE:	UNIT mm	
4/1	C	1/1	THIRD ANGLE PROJECTION	

UNLESS OTHERWISE SPECIFIED TOLERANCES
 3 PLACE ±0.5 ±0.10
 2 PLACE ±1.5 ±0.25
 1 PLACE ±2.0 ±0.50
 ANGLE DIM

EXCON
 EXCON TECHNOLOGY COMPANY

SCALE	REV.	PAGE:	UNIT	mm	DWG NO:	PART.NO
4/1	C	1/1	THIRD ANGLE	PROJECTION	C4202TA	420200TAxxx

PART NO. 420200TBxxx
 DWG NO. C4202TB

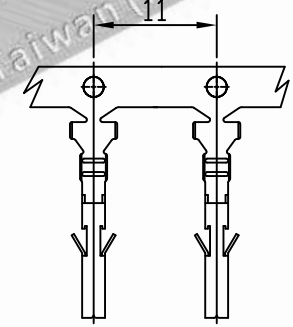
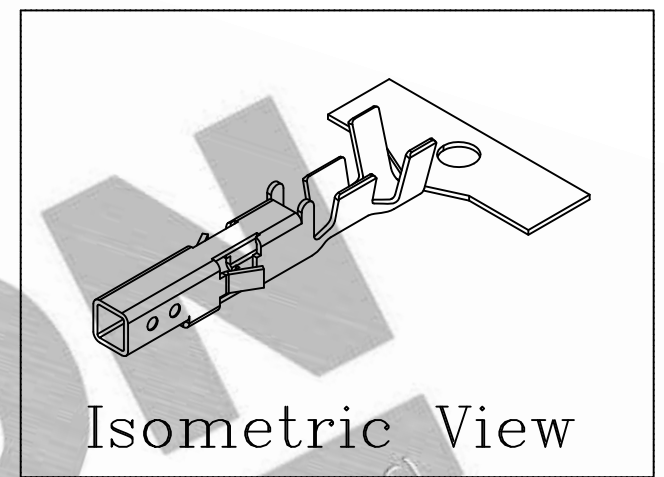
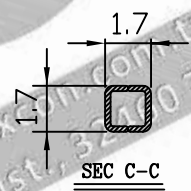
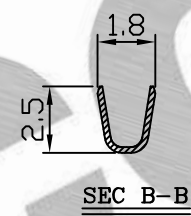
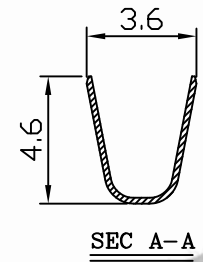
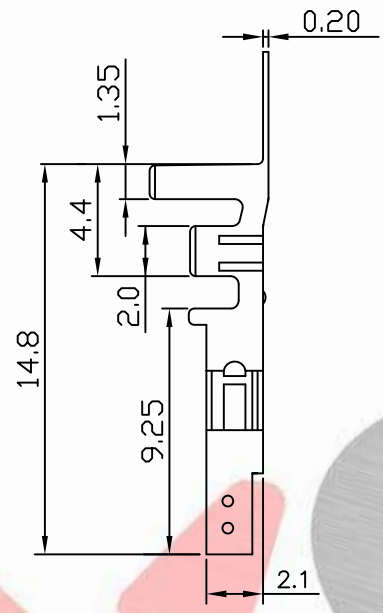
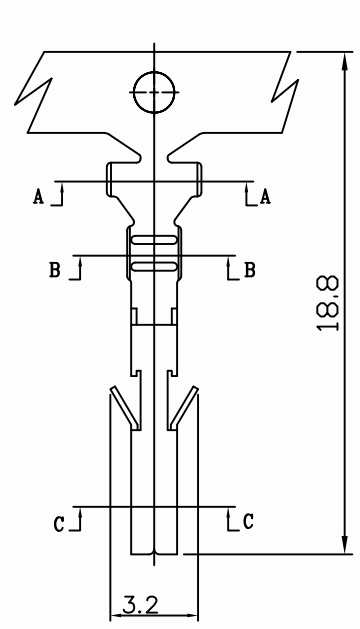

- NOTE:
- Terminal Material: Brass bronze or Phosphor bronze
 - Plated: Tin pre-plated 50u"min.
 - Current rating: 5A AC/DC
 - Voltage rating: 600V AC/DC
 - Withstand voltage: 1500V AC/minute
 - Insulation resistance: 1000MΩ min
 - Insulation O.D.: 1.1~2.1mm
 - Q'ty / reel: 4,000pcs

Dimensional & Ordering Information:

No.	Part No.	Wire Range	Material	Finishing
1	420200TB051	AWG#24~#18	Brass	Tin pre-plated
2	420200TB351	AWG#24~#18	Phosphor	Tin pre-plated

D	DWG RELEASE		Christy	12/24 2015
C	NOTE:修改 第2項 Tin-Plated → Tin Pre-Plated 新增 第3、4、5、6項及鍍厚T0.2		Christy	5/28 2015
REV.	REVISIONI		DIS	DATE
SCALE	REV.	PAGE:	UNIT	mm
4/1	D	1/1	THIRD ANGLE PROJECTION	

UNLESS OTHERWISE SPECIFIED TOLERANCES
 3 PLACE ±0.5 ±0.10
 2 PLACE ±1.5 ±0.25
 1 PLACE ±2.0 ±0.50
 ANGLE DIM



DWG NO:		PART.NO	
C4202TB		420200TBxxx	

10 9 8 7 6 5 4 3 2 1

PART NO. 420200TXxxx
 DWG NO. C4202TX

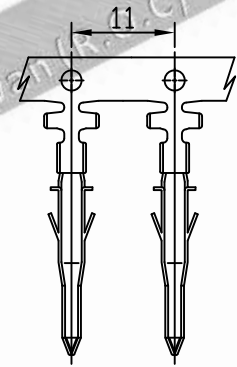
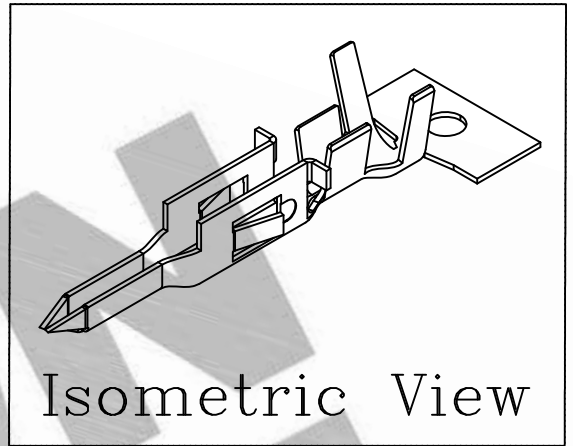
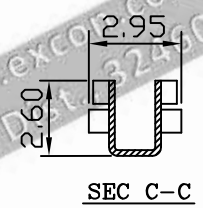
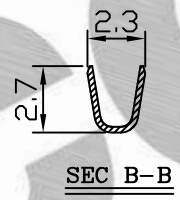
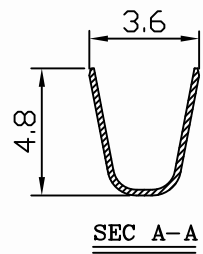
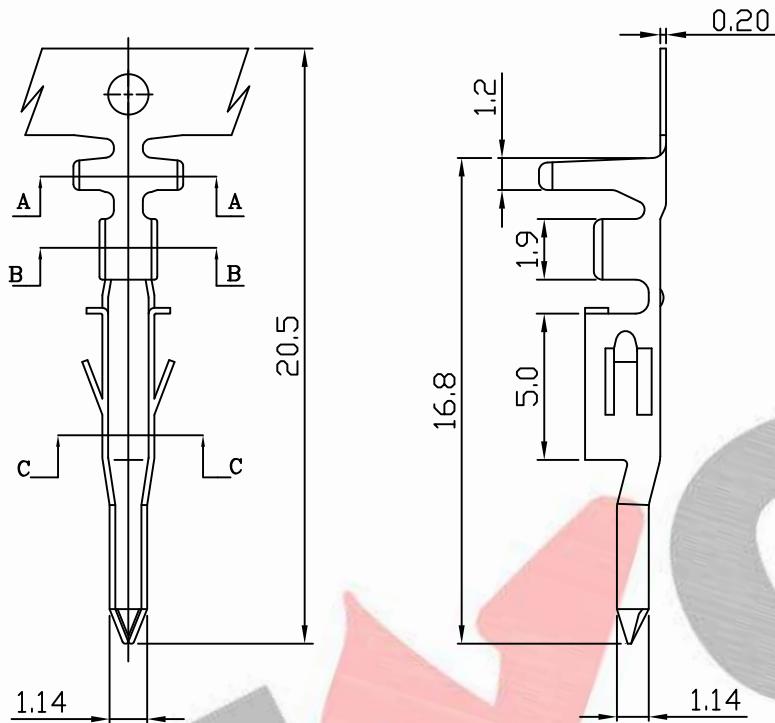

- NOTE:
1. Terminal Material: Brass bronze or Phosphor bronze
 2. Plated: Tin pre-plated 50u"min.
 3. Current rating: 5A AC/DC
 4. Voltage rating: 600V AC/DC
 5. Withstand voltage: 1500V AC/minute
 6. Insulation resistance: 1000MΩ min
 7. Insulation O.D.: 1.7~2.8mm
 8. Q'ty / reel: 4,000pcs

No.	Part No.	Wire Range	Material	Finishing
1	420200TX051	AWG#16~#20	Brass	Tin pre-plated
2	420200TX351	AWG#16~#20	Phosphor	Tin pre-plated

C		DWG RELEASE		Christy	1/7	UNLESS OTHERWISE SPECIFIED TOLERANCES 3 PLACE ±0.5 ±0.10 2 PLACE ±1.5 ±0.25 1 PLACE ±2.0 ±0.50 ANGLE DIM
REV.	REVISIONI			DIS	DATE	
SCALE	REV.	PAGE:	UNIT	mm		DWG NO:
4/1	C	1/1	THIRD ANGLE	PROJECTION		C4202TX

EXCON
 EXCON TECHNOLOGY COMPANY

PART.NO
 420200TXxxx

10 9 8 7 6 5 4 3 2 1

PART NO. 420200TYxxx
 DWG NO. C4202TY

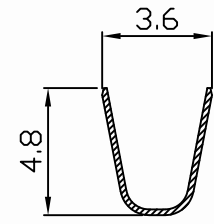
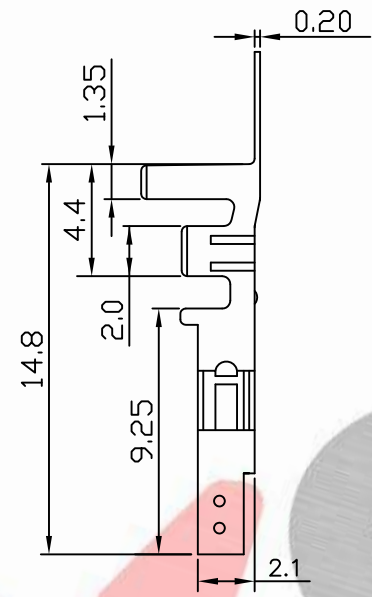
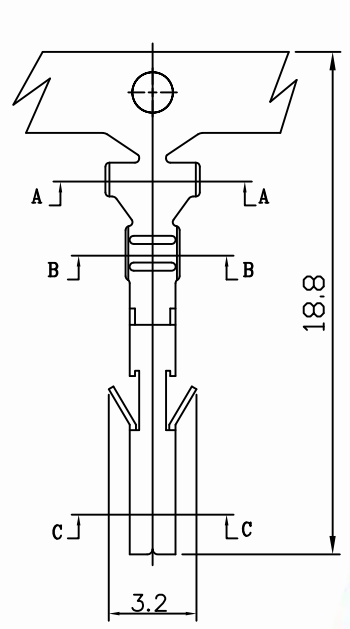

SEC A-A

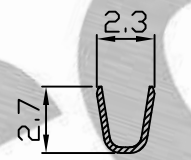

SEC B-B

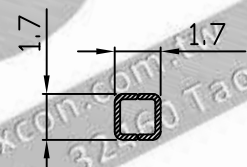

SEC C-C

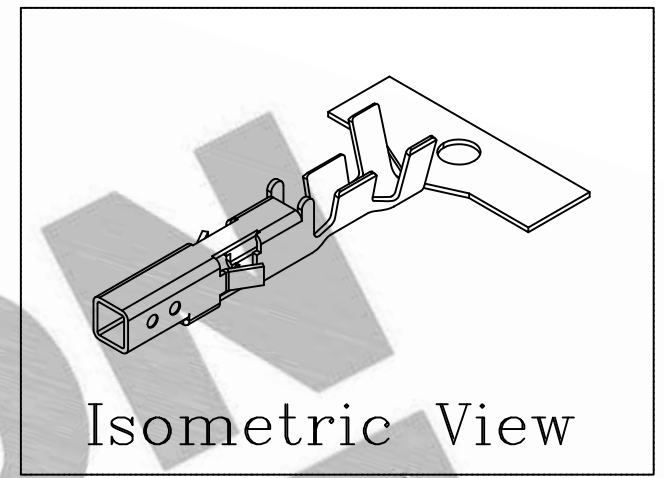

Isometric View

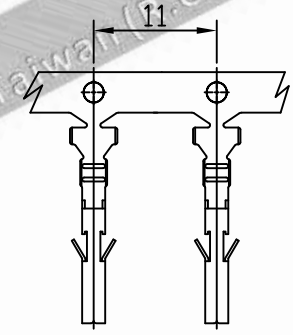

- NOTE:
1. Terminal Material: Brass bronze or Phosphor bronze
 2. Plated: Tin pre-plated 50u"min.
 3. Current rating: 5A AC/DC
 4. Voltage rating: 600V AC/DC
 5. Withstand voltage: 1500V AC/minute
 6. Insulation resistance: 1000MΩ min
 7. Insulation O.D.: 1.7~2.8mm
 8. Q'ty / reel: 4,000pcs

No.	Part No.	Wire Range	Material	Finishing
1	420200TY051	AWG#16~#20	Brass	Tin pre-plated
2	420200TY351	AWG#16~#20	Phosphor	Tin pre-plated

C		DWG RELEASE		Christy	1/7	UNLESS OTHERWISE SPECIFIED TOLERANCES 3 PLACE ±0.5 ±0.10 2 PLACE ±1.5 ±0.25 1 PLACE ±2.0 ±0.50 ANGLE DIM	EXCON EXCON TECHNOLOGY COMPANY
REV.	REVISIONI			DIS	DATE		
SCALE	REV.	PAGE:	UNIT	mm		DWG NO:	PART.NO
4/1	C	1/1	THIRD ANGLE	PROJECTION		C4202TY	420200TYxxx