

BOARD TO BOARD CONNECTOR FEMALE

3720 SERIES - 0.5MM PITCH



Specifications

- Electrical rating: AC/DC 50V 0.5A
- Insulation resistance: 500MΩ min
- Withstand Voltage: 200V AC/minute
- Operation temperature: -40°C to +105°C

Material

- Contact material: Phosphore bronze Gold plated
- Housing: LCP

Recommended P.C.B Layout(Top Side)
(PCB BOARD TOLERANCE±0.05)

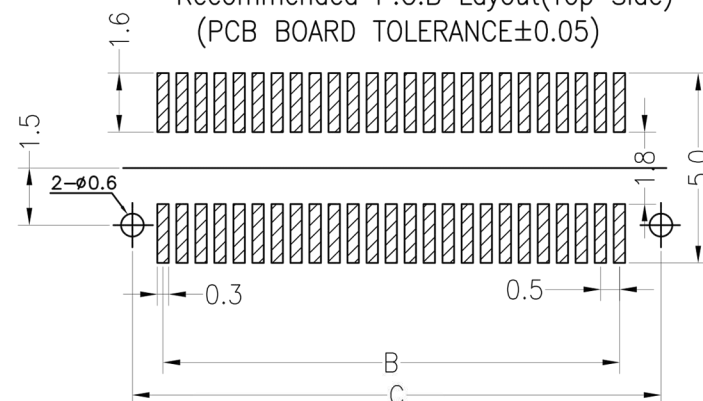

Ordering Information

3720F - XXX - 23 X (X) 01

1
2
3
4
5

1. Connector Series

2. Number of pins per row (20→100P)

3. Plastic height

- 23 = 2.3mm

4. Contact Plating

- A= Gold Flash
- B= 3U" Gold
- C= 5U" Gold
- D= 10U" Gold
- E= 15U" Gold
- F= 30U" Gold
- G= Gold Flash/Tin

5. Packaging

- T = Tube
- R = Reel

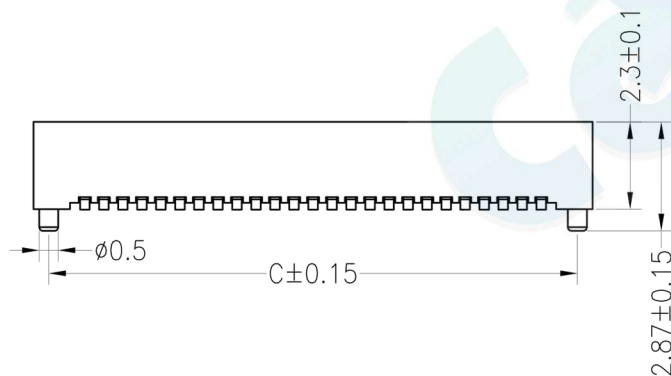
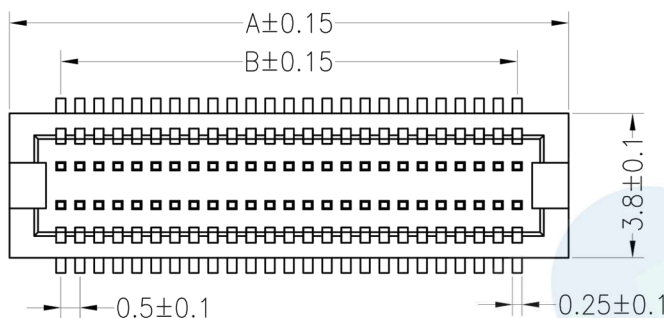
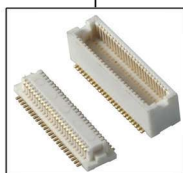

NO. OF Contacts	Dimensions		
	A	B	C
20pin	7.20	4.50	6.60
30pin	9.70	7.00	9.10
32pin	10.20	7.50	9.60
36pin	11.20	8.50	10.60
40pin	12.20	9.50	11.60
50pin	14.70	12.00	14.10
60pin	17.20	14.50	16.60
80pin	22.20	19.50	21.60
100pin	27.20	24.50	26.60

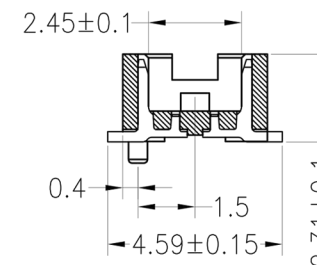

ASSEMBLY

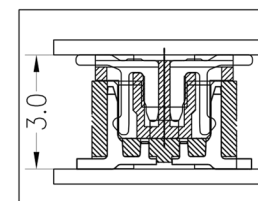

				OPERATION		DRAW	BEN	12.04.18	SCALE	FIT	votre partenaire en électronique						
				X.X	±0.30				CHECK	UNIT				mm	PART NO.	3720F-XXX-23X (X) 01	
				X.XX	±0.20	APPROVE	SIZE	A4						TITLE:		0.5BTB NPin H2.3 Female withpost	
				X.XXX	±0.10			DIM								TOL	1/1
A0	2012.04.18	NEW DRAWING							SHEET								
REV	DATE	MODIFICATION DESCRIPTION		CHANGE					PROJ.								

BOARD TO BOARD CONNECTOR FEMALE

3720 SERIES - 0.5MM PITCH



Specifications

- Electrical rating: AC/DC 50V 0.5A
- Insulation resistance: 500MΩ min
- Withstand Voltage: 200V AC/minute
- Operation temperature: -40°C to +105°C

Material

- Contact material: Phosphore bronze Gold plated
- Housing: LCP

Recommended P.C.B Layout(Top Side)
(PCB BOARD TOLERANCE±0.05)

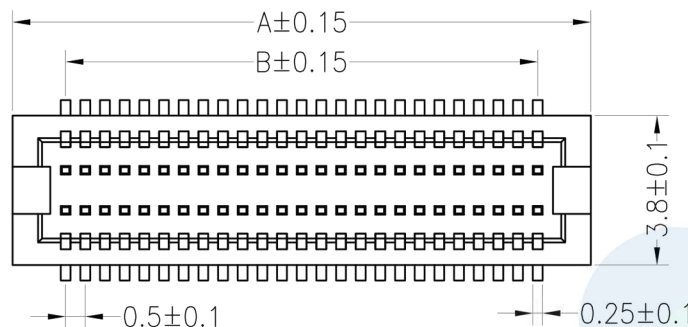
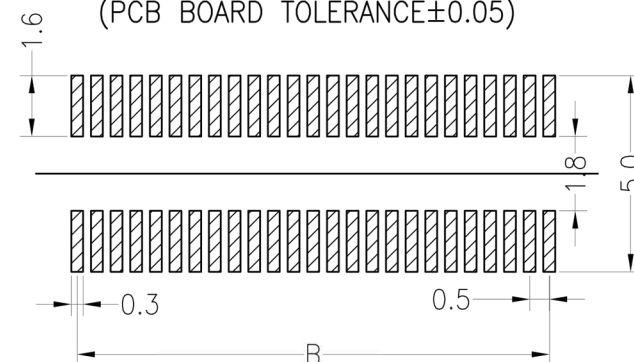

NO. OF Contacts	Dimensions	
	A	B
20pin	7.20	4.50
30pin	9.70	7.00
32pin	10.20	7.50
36pin	11.20	8.50
40pin	12.20	9.50
50pin	14.70	12.00
60pin	17.20	14.50
80pin	22.20	19.50
100pin	27.20	24.50

Ordering Information

3720F - XXX - 23 X (X) 02

1 2 3 4 5

1. Connector Series

2. Number of pins per row (20→100P)

3. Plastic height

- 23 = 2.3mm

4. Contact Plating

- A= Gold Flash
- B= 3U" Gold
- C= 5U" Gold
- D= 10U" Gold
- E= 15U" Gold
- F= 30U" Gold
- G= Gold Flash/Tin

5. Packaging

- T = Tube
- R = Reel

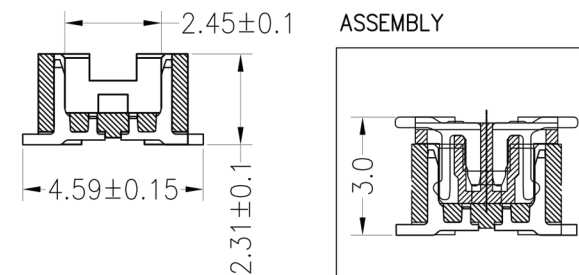
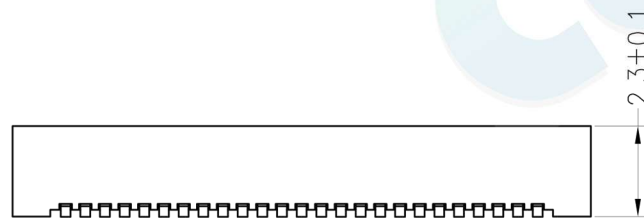
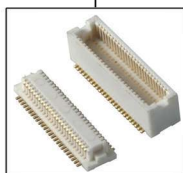

				OPERATION		DRAW	BEN	12.04.18	SCALE	FIT	 votre partenaire en électronique	
				X.X	±0.30							
				X.XX	±0.20	APPROVE			SIZE	A4	PART NO.	3720F-XXX-23X (X) 02
				X.XXX	±0.10							
REV	DATE	MODIFICATION DESCRIPTION	CHANGE	DIM	TOL							

BOARD TO BOARD CONNECTOR FEMALE

3720 SERIES - 0.5MM PITCH



Specifications

- Electrical rating: AC/DC 50V 0.5A
- Insulation resistance: 500MΩ min
- Withstand Voltage: 200V AC/minute
- Operation temperature: -40°C to +105°C

Material

- Contact material: Phosphore bronze Gold plated
- Housing: LCP

Ordering Information

3720F - XXX - 43 X (X) 02

1
2
3
4
5

1. Connector Series

2. Number of pins per row (20→100P)

3. Plastic height

- 43 = 4.3mm

4. Contact Plating

- A= Gold Flash
- B= 3U" Gold
- C= 5U" Gold
- D= 10U" Gold
- E= 15U" Gold
- F= 30U" Gold
- G= Gold Flash/Tin

5. Packaging

- T = Tube
- R = Reel

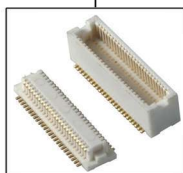

Recommended P.C.B Layout(Top Side)
(PCB BOARD TOLERANCE±0.05)

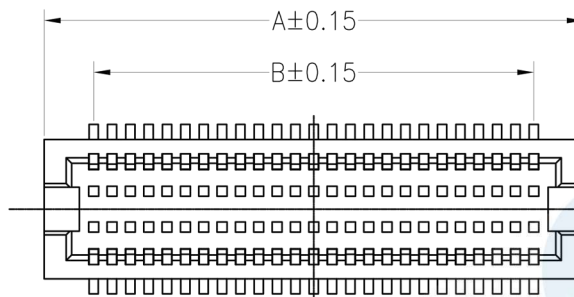
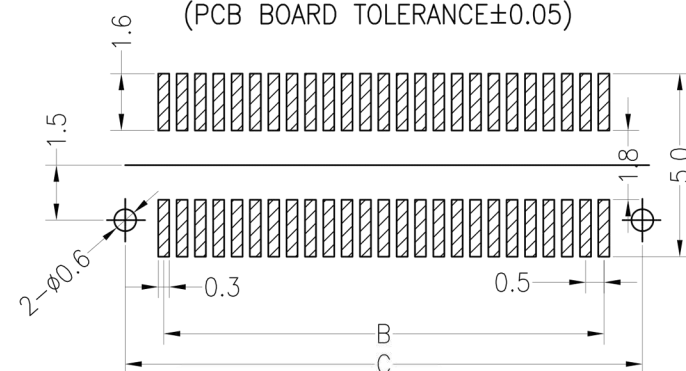

NO. OF Contacts	Dimensions		
	A	B	C
20pin	7.20	4.50	6.60
30pin	9.70	7.00	9.10
32pin	10.20	7.50	9.60
36pin	11.20	8.50	10.60
40pin	12.20	9.50	11.60
50pin	14.70	12.00	14.10
60pin	17.20	14.50	16.60
80pin	22.20	19.50	21.60
100pin	27.20	24.50	26.60

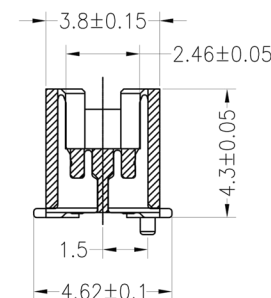
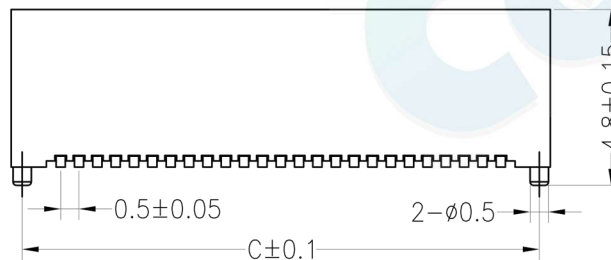

ASSEMBLY

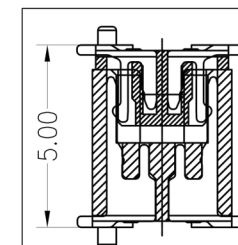

				OPERATION		DRAW	BEN	12.04.18	SCALE	FIT	 votre partenaire en électronique	
				X.X	±0.30							
A0	2012.04.18	NEW DRAWING		X.XX	±0.20	APPROVE			A4	1/1	TITLE:	0.5BTB NPin H4.3 Female
REV	DATE	MODIFICATION DESCRIPTION	CHANGE	Angle	±3°							