

BOARD TO BOARD CONNECTOR FEMALE

3720 SERIES - 0.5MM PITCH



Specifications

- Electrical rating: AC/DC 50V 0.5A
- Insulation resistance: 500MΩ min
- Withstand Voltage: 150V AC/minute
- Operation temperature: -40°C to +105°C

Material

- Contact material: Phosphore bronze Gold plated
- Housing: LCP

Ordering Information

3720F - XXX - 43 X (X) 01

1
2
3
4
5

1. Connector Series

2. Number of pins per row (20→100P)

3. Plastic height

- 43 = 4.3mm

4. Contact Plating

- A= Gold Flash
- B= 3U" Gold
- C= 5U" Gold
- D= 10U" Gold
- E= 15U" Gold
- F= 30U" Gold
- G= Gold Flash/Tin

5. Packaging

- T = Tube
- R = Reel

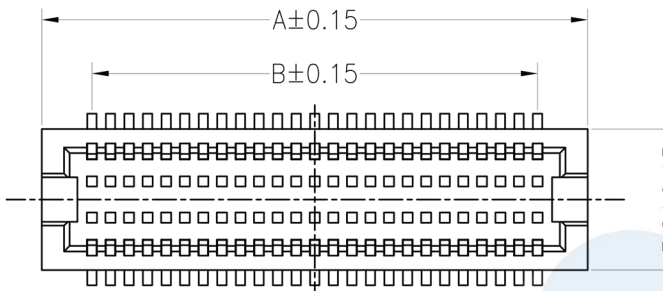
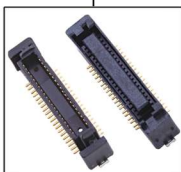

Recommended P.C.B Layout(Top Side)
(PCB BOARD TOLERANCE±0.05)

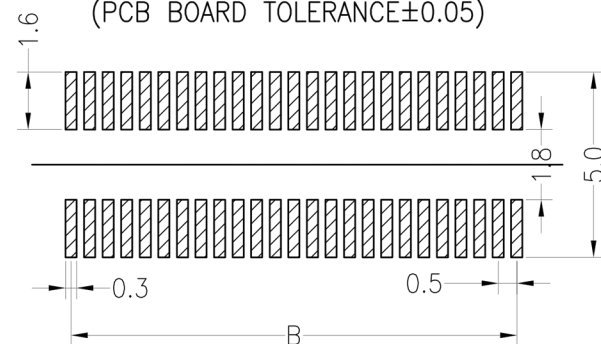

NO. OF Contacts	Dimensions	
	A	B
20pin	7.20	4.50
30pin	9.70	7.00
32pin	10.20	7.50
36pin	11.20	8.50
40pin	12.20	9.50
50pin	14.70	12.00
60pin	17.20	14.50
80pin	22.20	19.50
100pin	27.20	24.50

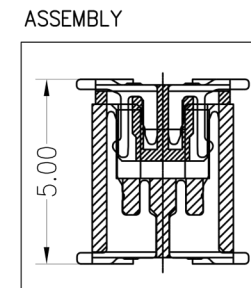
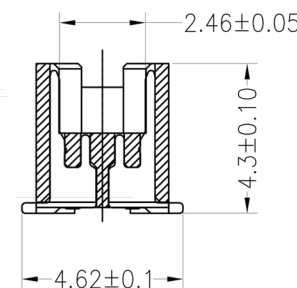

				OPERATION		DRAW	BEN	12.04.18	SCALE	FIT	votre partenaire en électronique	
				X.X	±0.30							
				X.XX	±0.20	CHECK			SIZE	A4	PART NO.	3720F-XXX-43X (X) 01
				X.XXX	±0.10		APPROVE					SHEET
REV	DATE	MODIFICATION DESCRIPTION	CHANGE	DIM	TOL	PROJ.						