

IC SOCKET DIP MALE

3661 SERIES - 1.778MM PITCH



Materials

- Pin: Brass, machined, (H59-3)
- Plating: Gold plated: 1.25u"m/50 u"nickel,full gold
- Insulator body (black): PPS/PBT (UL94V-0)

Electrical

- Current rating: 2.0 Amps
- Contact resistance: 20mΩ max
- Insulation resistance: 1000MΩ min
- Operating voltage: 60 AC/DC

Mechanical

- Operating temperature: -40°C to 105°C
- Soldering temperature: 260°C, 10s max

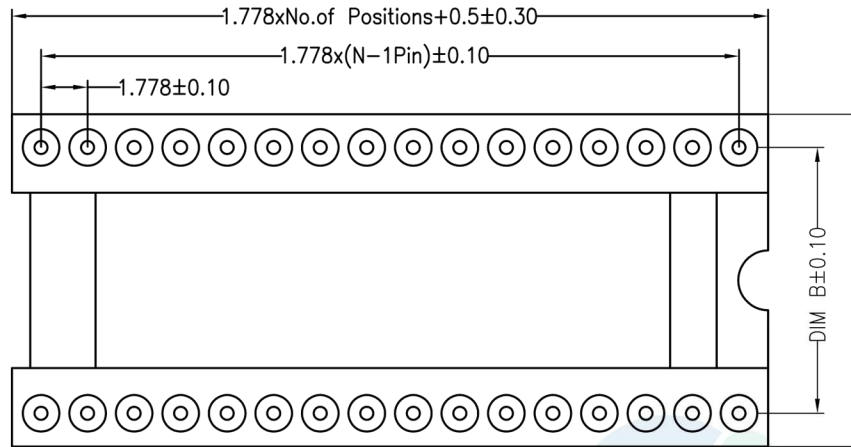

No. of Positions	B	C
16	7.62	10.16
24	10.16	12.7
28	10.16	12.7
30	10.16	12.7
32	10.16	12.7
48	10.16	12.7
20	15.24	17.64
24	15.24	17.64
28	15.24	17.64
40	15.24	17.64
42	15.24	17.64
48	15.24	17.64
52	15.24	17.64
56	15.24	17.64
64	15.24	17.64
68	15.24	17.64
64	19.05	21.45

Ordering Information

3661D - 28 (XX) - AAA B C

1
2
3
4
5
6

1. Connector Series

2. (H) Hauteur isolant

- H = 28 (Hauteur isolant : 2.80mm)

3. Number of pins per row

- 4. Pin Length (100 = 10.0mm)

5. Contact Plating

- A = Tin
- B = Gold Flash
- C = 2U" Gold
- D = 3U" Gold
- E = 5U" Gold
- F = 10U" Gold
- G = Gold Flash/Tin (*Standard)

6. Insulator Type

- A = 7.62PH
- B = 10.16PH
- C = 15.24PH

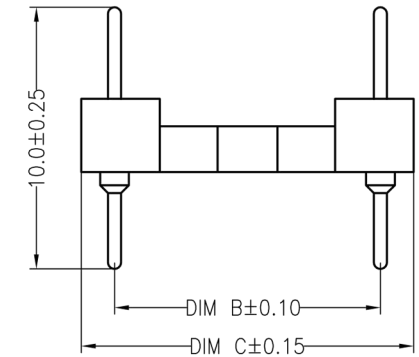
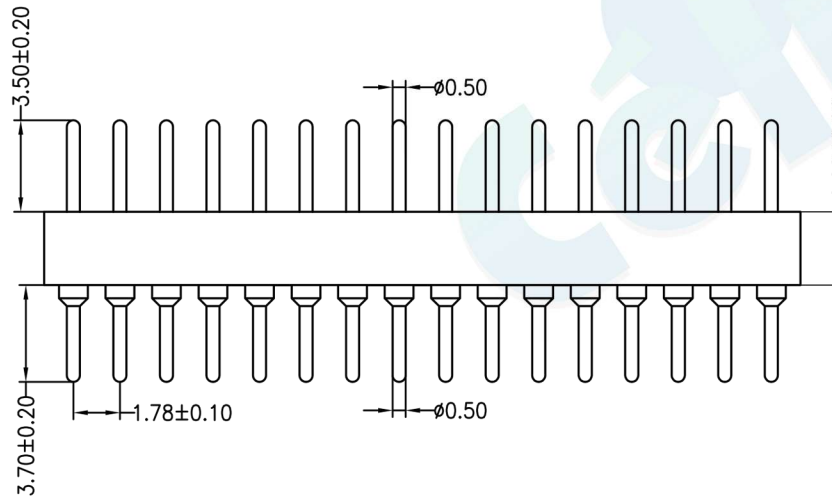
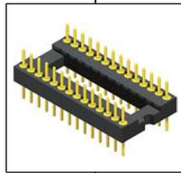

				OPERATION		DRAW	BEN	12.04.18	SCALE	FIT	votre partenaire en électronique	
				X.X	±0.30				UNIT	mm		
				X.XX	±0.20	CHECK			SIZE	A4	PART NO.	3661S - 28XX - XXXXX
				X.XXX	±0.10				SHEET	1/1		
A0	2012.04.18	NEW DRAWING		Angle	±3°	APPROVE			PROJ.	◆	TITLE:	1.778X2.8 IC Socket 180° L=10.0mm
REV	DATE	MODIFICATION DESCRIPTION		DIM	TOL							