

FEMALE HEADER ROUND PIN SMT SINGLE ROW

3624 SERIES - 1.27MM PITCH



Technical Specs

- Insulator: Black Glass filled polyester PPS
- Flammability: UL94V-O
- Sleeve: Brass
- Contact clip (3 finger): Beryllium copper (C17300)
- Accepted pin: Ø0.38 to 0.50mm
- Mechanical life: min 500 cycles
- Rated Current: 1A

- Forces: (polished steel gauge Ø0.41mm)
 - Insertion 0.5 N typ
 - Withdrawal 0.2 N typ
- Contact Resistance: max 20mΩ
- Dielectric Resistance: min 500MΩ

Ordering Information

3624S1 - 41 (XX) - AAA B 0X*

1. Connector Series

2. (H) Hauteur isolant

- H = 41 (Hauteur isolant : 4.1mm)

3. Number of pins per row

4. Pin Length (064 = 6.4mm)

5. Contact Plating

- A = Tin
- B = Gold Flash (*Standard)
- C = 2U" Gold
- D = 3U" Gold
- E = 5U" Gold
- F = 10U" Gold
- G = Gold Flash/Tin

(01)* = Type 1

(02)* = Type 2

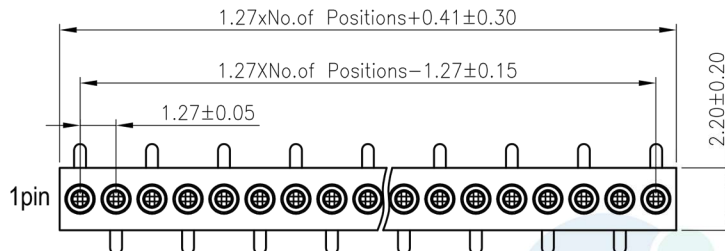
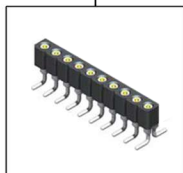

Type 2

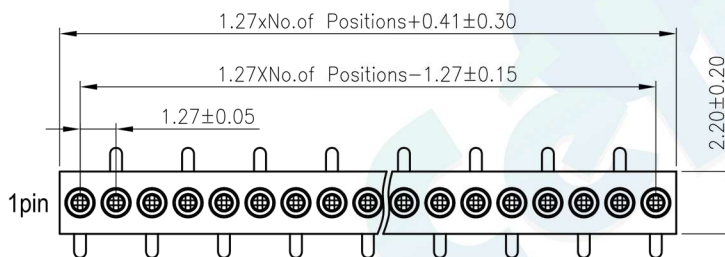

Type 1

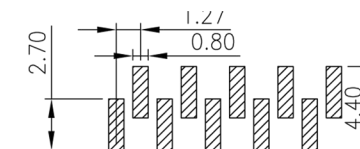
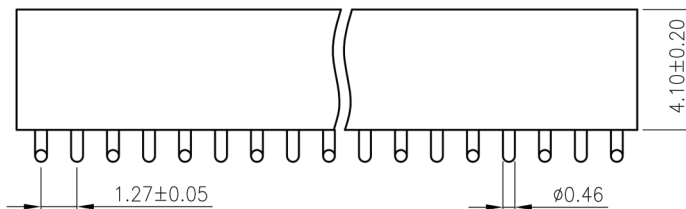

Type 1

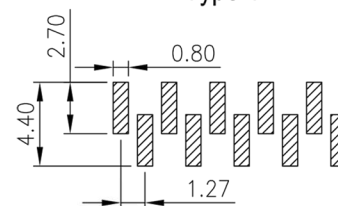

Type 2

Recommended P.C.B Layout

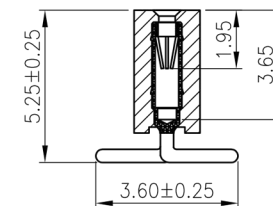

				OPERATION		DRAW	BEN	12.04.18	SCALE	FIT	 votre partenaire en électronique	
				X.X	±0.30				CHECK	UNIT		
				X.XX	±0.20	APPROVE	SIZE	A4				
				X.XXX	±0.10		SHEET	1/1				
A0	2012.04.18	NEW DRAWING		Angle	±3°	PROJ.	◆	PART NO.	3624S1 - 41XX - XXXX 0X			
REV	DATE	MODIFICATION	DESCRIPTION	DIM	TOL			TITLE:	1.27x4.1 Machine Female Header SMT L=6.4mm			