

FEMALE HEADER ROUND PIN SMT DUAL ROW

3620 SERIES - 2.54MM PITCH



Technical Specs

- Insulator: Black Glass filled polyester PPS
- Flammability: UL94V-O
- Sleeve: Brass CuZn36Pb3 (C36000)
- Contact clip (4 finger): Beryllium copper (C17200)
- Accepted pin: Ø0.40 to 0.56mm
- Mechanical life: min 500 cycles
- Rated Current: 3A
- Forces: (polished steel gauge Ø0.43mm)
 - Insertion 2 N typ
 - Withdrawal 1 N typ
- Contact Resistance: max 10mΩ
- Dielectric Resistance: min 1000MΩ
- Coplanarity SMD terminations: max 0.1mm
(measured on 25mm long connectors)

Ordering Information

3620S2 - 30 (XX) - AAA B (1)

1. Connector Series

2. (H) Hauteur isolant

- H = 30 (Hauteur isolant : 3.0mm)

3. Number of pins per row

4. Pin Length (074 = 7.4mm)

5. Contact Plating

- A = Tin
- B = Gold Flash (*Standard)
- C = 2U" Gold
- D = 3U" Gold
- E = 5U" Gold
- F = 10U" Gold
- G = Gold Flash/Tin

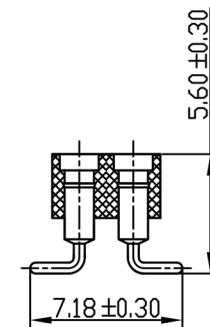
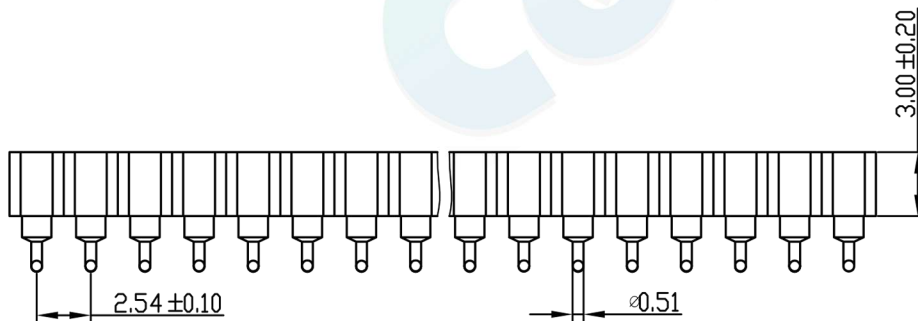
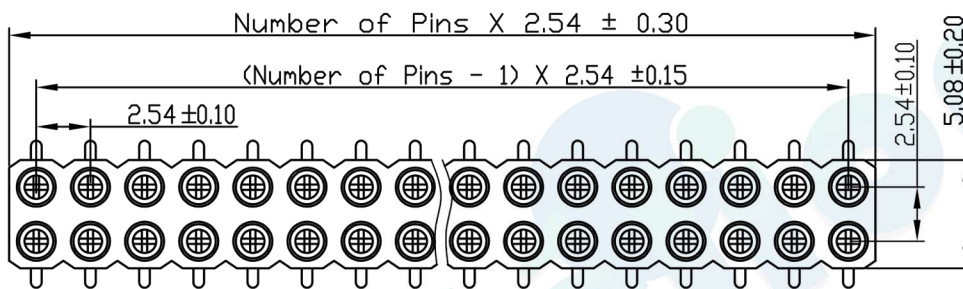
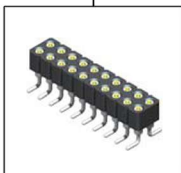

(1). Packaging

Ø=PE Bag 1=Tube 2=Reel

				OPERATION		DRAW	BEN	12.04.18	SCALE	FIT	 votre partenaire en électronique		
				X.X	±0.30				UNIT	mm			
				X.XX	±0.20	CHECK		SIZE	A4	PART NO.			3620S2 - 30XX - XXXX
				X.XXX	±0.10	APPROVE		SHEET	1/1	TITLE:			2.54X3.0 Machine Female Header SMT L=7.4
REV	DATE	MODIFICATION DESCRIPTION	CHANGE	DIM	TOL			PROJ.					

FEMALE HEADER ROUND PIN SMT DUAL ROW

3620 SERIES - 2.54MM PITCH



Technical Specs

- Insulator: Black Glass filled polyester PPS
- Flammability: UL94V-O
- Sleeve: Brass
- Contact clip (6 finger): Beryllium copper (C17200)
- Accepted pin: Ø0.70 to 0.90mm, 0.635mm
- Mechanical life: min 500 cycles
- Rated Current: 3A
- Forces: (polished steel gauge Ø0.76mm)
 - Insertion 2 N typ
 - Withdrawal 1 N typ
- Contact Resistance: max 10mΩ
- Dielectric Resistance: min 1000MΩ
- Coplanarity SMD terminations: max 0.1mm
(measured on 25mm long connectors)

Ordering Information

3620S2 - 70 (XX) - AAA B (1)

1. Connector Series

2. (H) Hauteur isolant

- H = 70 (Hauteur isolant : 7.0mm)

3. Number of pins per row

4. Pin Length (124 = 12.4mm)

5. Contact Plating

- A = Tin
- B = Gold Flash (*Standard)
- C = 2U" Gold
- D = 3U" Gold
- E = 5U" Gold
- F = 10U" Gold
- G = Gold Flash/Tin

(1). Packaging

Ø=PE Bag 1=Tube 2=Reel

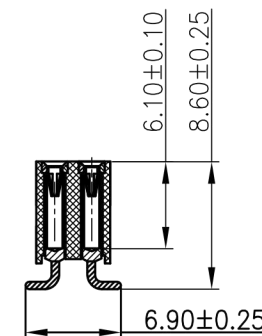
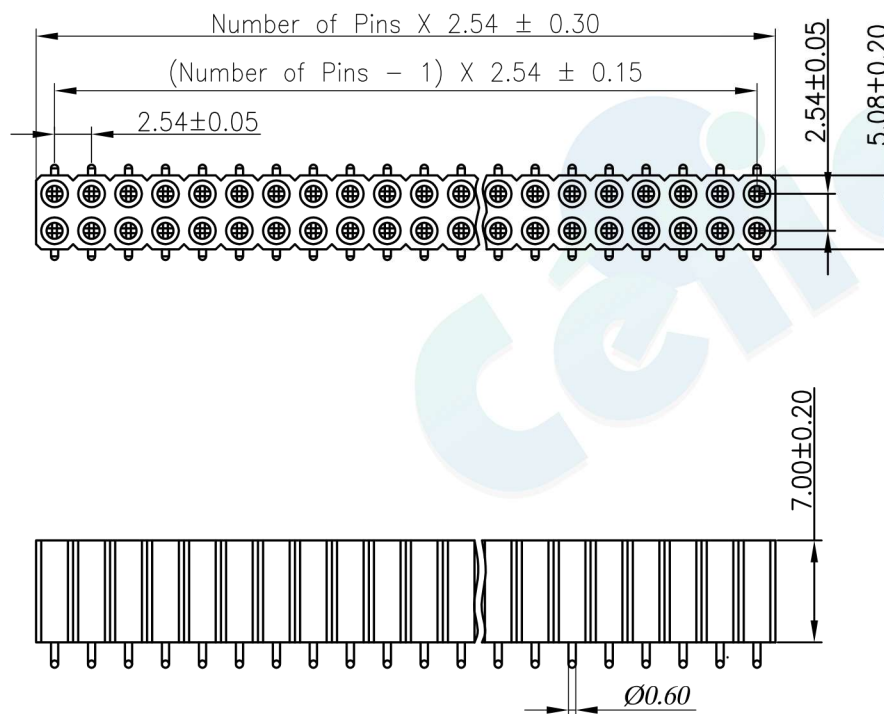
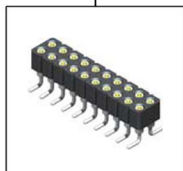

				OPERATION		DRAW	BEN	12.04.18	SCALE	FIT	 votre partenaire en électronique		
				X.X	±0.30				UNIT	mm			
				X.XX	±0.20	CHECK	SIZE	A4	PART NO.	3620S2 - 70XX - XXXX			
				X.XXX	±0.10		SHEET	1/1	TITLE:	2.54x7.0 Machine Female Header SMT L=10.0			
REV	DATE	MODIFICATION DESCRIPTION	CHANGE	Angle	±3°	APPROVE		PROJ.					