



# BOX HEADER CONNECTOR SMT

## 3214 SERIES - 2.54MM PITCH



### Specifications

- Current rating: 3.0 Amps
  - Contact resistance: 20mΩ max
  - Withstand voltage: 1000V AC/DC
  - Insulation resistance: 1000MΩ min
  - Operation temperature: -40°C to +105°C
  - Contact material: Brass
  - Contact plating: Au Or Sn Over Ni
  - Insulator material: Polyester (UL94V-0)
  - Standard: PA6T
- Max. processing Temp: 230°C for 30-60 seconds  
260°C for 10 seconds

Recommended P.C.B Layout(Top Side)  
(PCB BOARD TOLERANCE±0.05)

### Ordering Information

**3214S - XX A B 03 (1)**

1
2
3
4

#### 1. Connector Series

#### 2. Number of pins (6→64P)

#### 3. Contact Plating

- A=Gold Flash
- B= 3U" Gold
- C=5U" Gold
- D=10U" Gold
- E= 15U" Gold
- F= 30U" Gold
- G=Gold Flash/Tin
- H=Tin

#### 4. Insulator Material Option

- A = BK-PBT
- B = BK-PA66
- C = BK-PA6T
- D=BK-PA46
- E=BK-PA9T
- F=BK-LCP

#### (1). Packaging

Ø=PE Bag 1=Tube 2=Tray 3=Tube+Cap 4=Reel+Cap

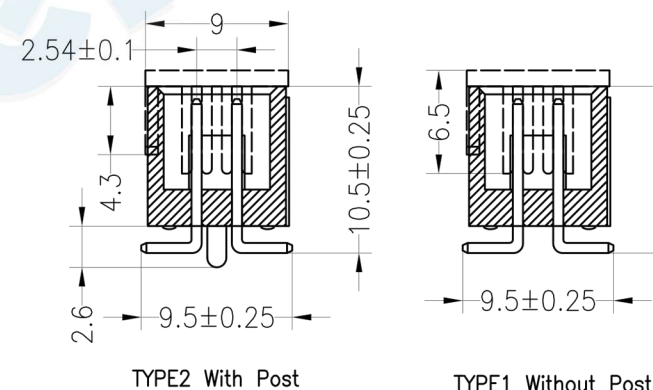
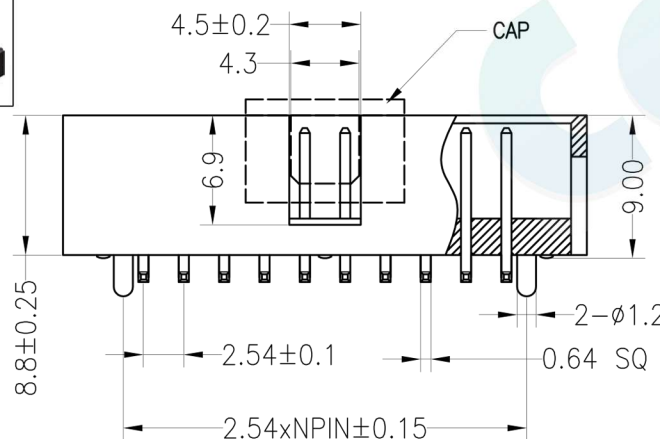
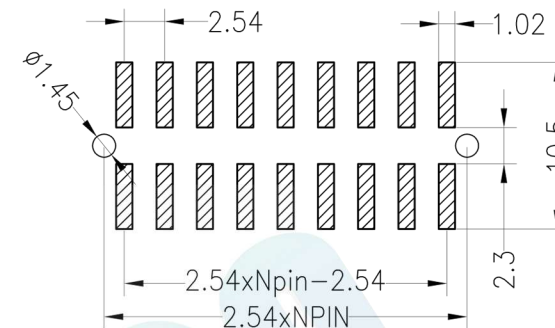
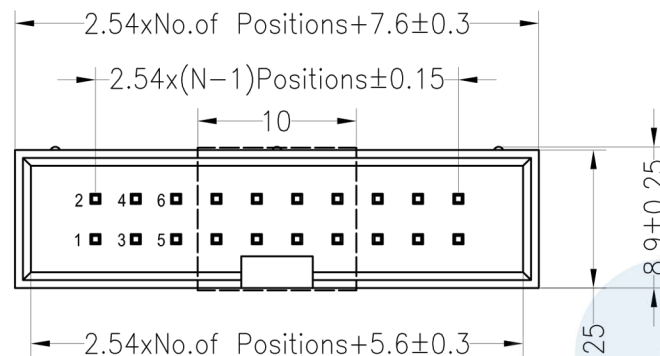
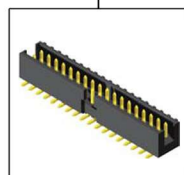

				OPERATION		DRAW	BEN	12.04.18	SCALE	FIT	 votre partenaire en électronique	
				X.X	±0.30							
				X.XX	±0.20	APPROVE	SIZE	A4	PART NO.	3214S-XXXX 03 (1)		
				X.XXX	±0.10					APPROVE	SHEET	1/1
REV	DATE	MODIFICATION DESCRIPTION	CHANGE	Angle	±3°	DIM	TOL	PROJ.				

# BOX HEADER CONNECTOR SMT

## 3214 SERIES - 2.54MM PITCH



### Specifications

- Current rating: 3.0 Amps
  - Contact resistance: 20mΩ max
  - Withstand voltage: 1000V AC/DC
  - Insulation resistance: 1000MΩ min
  - Operation temperature: -40°C to +105°C
  - Contact material: Brass
  - Contact plating: Au Or Sn Over Ni
  - Insulator material: Polyester (UL94V-0)
  - Standard: PA9T
- Max. processing Temp: 230°C for 30-60 seconds  
260°C for 10 seconds

Recommended P.C.B Layout (Top Side)  
(PCB BOARD TOLERANCE ±0.05)

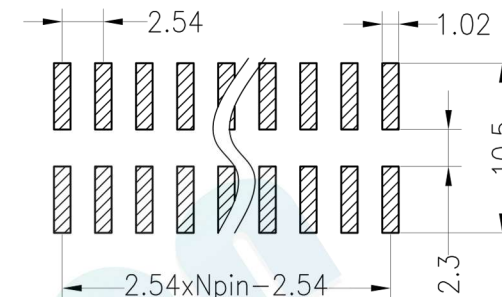

### Ordering Information

**3214S - XX A B 04 (1)**

#### 1. Connector Series

#### 2. Number of pins (6→68P)

#### 3. Contact Plating

- A= 0.8U" Gold
- B= 1U" Gold
- C= 1.5U" Gold
- D= 2U" Gold
- E= 3U" Gold
- F= 5U" Gold
- G=10U" Gold
- H=15U" Gold
- I= Gold Flash/Tin
- J= Tin

#### 4. Insulator Material Option

- A = BK-PBT
- B = BK-PA66
- C = BK-PA6T
- D=BK-PA46
- E=BK-LCP

(1). Packaging Ø=PE Bag 1=Tray 2=Tube 3=Tube+Cap

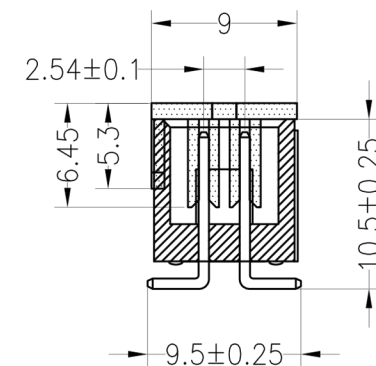
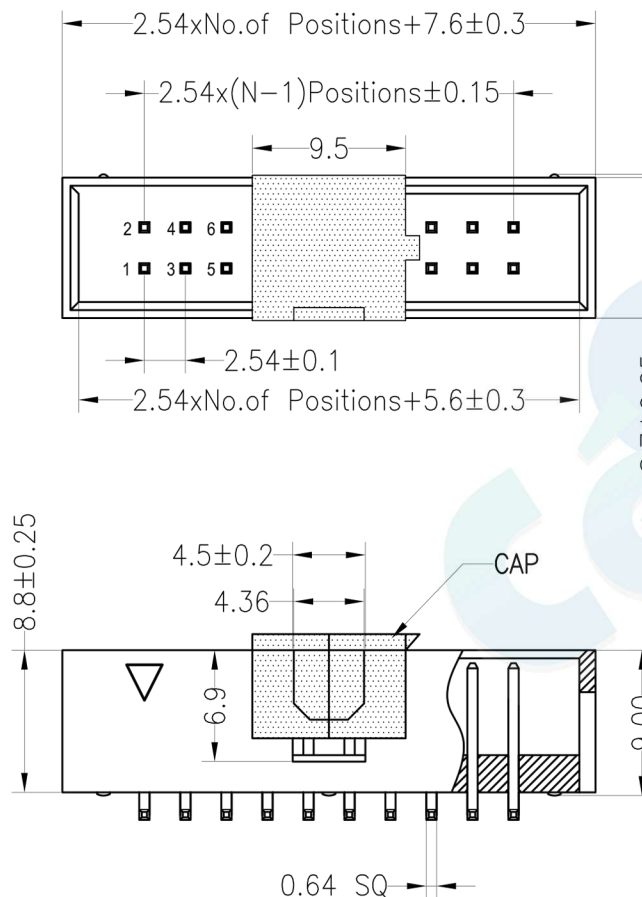
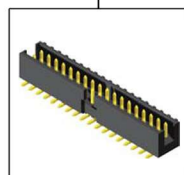

OPERATION		DRAW	BEN	12.04.18	SCALE	FIT
X.X	±0.30					
X.XX	±0.20	CHECK			UNIT	mm
X.XXX	±0.10					
Angle	±3°	APPROVE			SIZE	A4
DIM	TOL					
		PROJ.			SHEET	1/1



A0	2012.04.18	NEW DRAWING																
REV	DATE	MODIFICATION DESCRIPTION	CHANGE															

PART NO.	3214S-XXXX 04 (1)
TITLE:	2.54mm Box Header H8.8mm SMT