

WAFER CONNECTOR SMT RIGHT ANGLE

3001 SERIES - 3.00MM



Specifications

- Rated current: 5.0AMP
- Voltage rating: 250V AC/DC
- Contact resistance: 20mΩ max
- Withstand Voltage: 1500V AC/minute
- Insulation resistance: 1000MΩ min
- Operation temperature: -40°C to +105°C
- Contact material: Brass
- Contact plating: Tin Over Ni
- Solder Tabs material: Brass/Tin plated
- Insulator material: Polyester (UL94V-0)
- Standard: LCP
- Max. processing Temp: 230°C for 30-60 seconds
260°C for 10 seconds

Ordering Information

3001SR1 - (XX) X X 03 (1)

1
2
3
4

1. Connector Series
2. Number of pins per row (02→12)
3. Insulator Material Option

- A = BK-PA6T
- B = BK-PA9T
- C = BK-LCP

4. Contact plating

- A = Gold Flash
- B = Gold Flash/Tin
- C = Tin
- D = Matte-Tin

(1). Packaging

Ø=Pe Bag 1=Tube 2=Reel

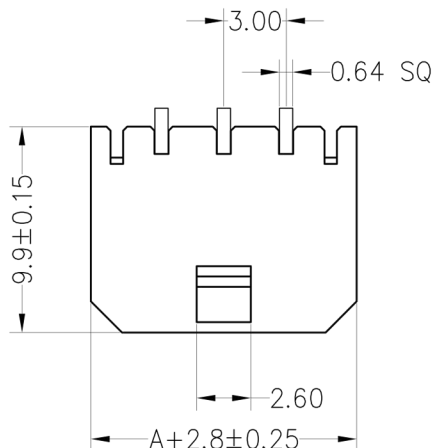
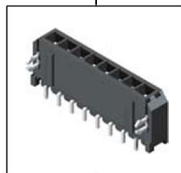

PIN NO.	Dimensions (mm)		
	A	B	C
02	6.85	3.00	
03	9.85	6.00	
04	12.85	9.00	4.70
05	15.85	12.00	7.70
06	18.85	15.00	10.70
07	21.85	18.00	13.70
08	24.85	21.00	16.70
09	27.85	24.00	19.70
10	30.85	27.00	22.70
11	33.85	30.00	25.70
12	36.85	33.00	28.70

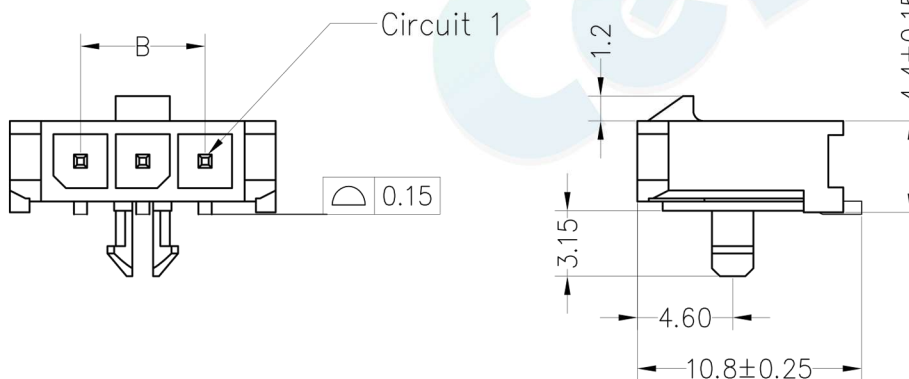

Recommended P.C.B Layout(Top Side)
(PCB BOARD TOLERANCE±0.05)

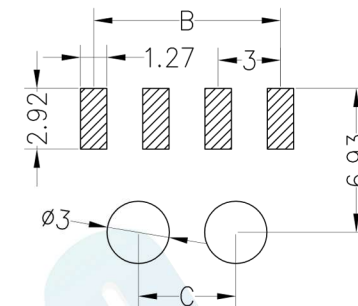

4-12P PCB LAYOUT

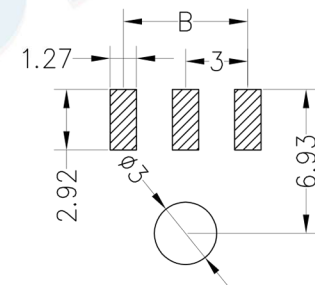

2-3P PCB LAYOUT

				OPERATION		DRAW	BEN	12.04.18	SCALE	FIT	votre partenaire en électronique	
				X.X	±0.30							
				X.XX	±0.20	APPROVE			SIZE	A4	PART NO.	3001SR1 - XXXX 03
				X.XXX	±0.10							
REV	DATE	MODIFICATION DESCRIPTION	CHANGE	DIM	TOL							