

# PIN HEADER DIP SINGLE ROW DOUBLE PLASTIC

## 11 SERIES - 5.08MM PITCH



Recommended P.C.B Layout (Top Side)  
(PCB BOARD TOLERANCE ±0.05)

### Specifications

- Rated Current: 7.0AMP
- Contact Resistance: 20mΩ Max
- Withstand Resistance: 500V AC/DC
- Insulation Resistance: 1000MΩ Min
- Operation Temperature: -40°C to +105°C
- Contact Material: Brass
- Contact Plating : Sn Over Ni
- Insulator Material : Polyester (UL94V-0)
- Standard : LCP
- Max. Processing Temp : 230° for 30-60 seconds  
260° for 5seconds

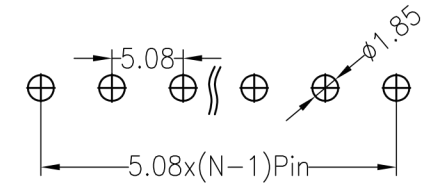

### Ordering Information

**1125D - 21 (XX) - AAA - B C P (1)**

#### 1. Connector Series

#### 2. (H) Hauteur isolant

- H = 25 (Hauteur isolant : 2.5mm)

#### 3. Number of pins per row

#### 4. Pin Length

#### 5. Insulator Material Option

- A = BK-PBT
- B = BK-PA66
- C = BK-PA6T
- D = BK-PA46
- E = BK-LCP

#### 6. Contact Plating

- A = Gold Flash
- B = 5U" Gold
- C = 10U" Gold
- D = 15U" Gold
- E = 30U" Gold
- F = Gold Flash/Tin
- G = Tin

#### 7. Post

- W (With Post)
- Ø (No Post)

#### (1). Packaging

Ø = PE Bag 1=Tray 2=Tube 3=Tube+Cap 4=Reel+Cap 5=Reel+Mylar

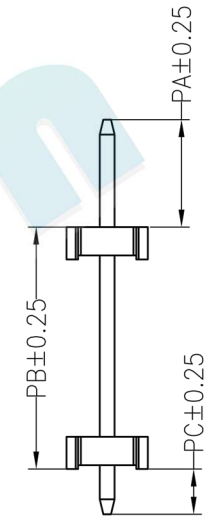
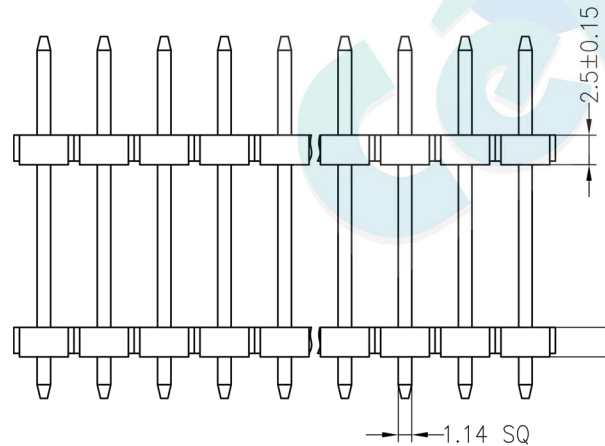
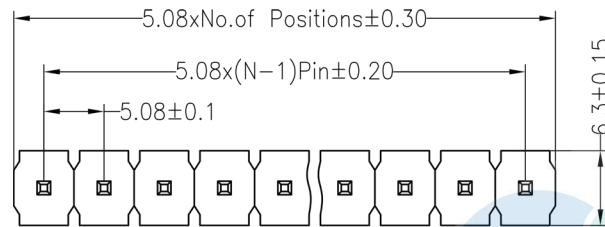
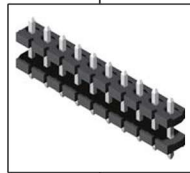

Dimension antitheses list

ITEM	PA	PB	PC	L
Standard	8.00	5.00	3.50	16.5
Alternate				

### OPERATION

X.X	±0.30
X.XX	±0.20
X.XXX	±0.10
Angle	±3°
DIM	TOL

DRAW

YiYuSheng

12.03.28

SCALE

FIT

UNIT

mm

SIZE

A4

SHEET

1/1

PROJ.



PART NO.

1125D - 21XX - XXX - XXX

TITLE:

5.08PH 1xNpin 2+H2.5mm 180°

A

REV

DATE

MODIFICATION DESCRIPTION

CHANGE

APPROVE

5

PROJ.



7

PART NO.

1125D - 21XX - XXX - XXX

TITLE:

5.08PH 1xNpin 2+H2.5mm 180°

A

REV

1

2

3

4

5

6

7

8

9